

For Immediate Release: July 2025

#40137 Team Associated RC10 Trail Truck



ELECTRIC ■ OFF ROAD ■ 1:10 SCALE ■ 4 WHEEL DRIVE ■ KIT

A performance rig built to endure. When hitting the trail, you want to do it with confidence and the answer is the RC10 Trail Truck Portal Kit!

At the heart of the RC10 Trail Truck Portal Kit is our revolutionary Stealth® X gearbox. Although the exterior appears to have a conventional 3-gear transmission look, the inside is far from conventional. The Stealth® X features the ability to adjust the rear drive ratio independently of the front drive across three levels: stock overdrives the front end 5.7%, option 1 provides a one-to-one drive ratio front-to-rear (available separately), and option 2 overdrives the front end 11.83%. Feeding the power to the tires are 3-piece telescopic driveshafts with an extruded aluminum center section, universal front drive axles, and hardened steel ring and pinion gears. With the Enduro drivetrain, delivering useful power will not be an issue.

The RC10 Trail Truck Portal Kit features new high-clearance portal axles. These new portal axles include all-metal gears, ball bearings, and a new larger pocket for a heavier-duty inner input bearing. With almost an inch more clearance than our standard straight axles, these axles are a perfect fit for the Enduro line-up.

With all this packed in one box, we know the RC10 Trail Truck Portal Rock Crawler Kit is ready for the trail – Are you?



CHASSIS FEATURES

BTA STEERING & ALUMINUM STEERING PLATES:

Behind-the-axle steering provides better approach angles, more clearance, and a cleaner look. Bolt-on aluminum steering plates allow for more adjustments, strength, and future modifications. Integrated servo winch mount: Mounting a winch directly to the chassis is the strongest and most reliable spot on any trail rig, positioned alongside the steering servo for overall chassis balance and weight distribution.



Threaded Aluminum shock bodies: Threaded gold anodized aluminum and fluid-filled, these shocks keep the vehicle stable on the trail and retain oil even in the roughest terrain.

PORTAL AXLES:

When it comes to rock crawling, ground clearance is crucial. That's why this Enduro Kit includes our all-new high-clearance portal axles. With almost an inch of added center axle clearance, over standard straight axles, getting over tough obstacles is a breeze. To battle the massive amount of torque inherent with portal axles, we not only utilize metal gears throughout, but also use six screws to hold the portal gear boxes tight. With that many screws it means a stronger portal box and less chance of gears pulling apart under heavy loads.



Included is our performance-proven Stealth® X transmission that features the ability to adjust the rear drive ratio. In the box you get the standard 5.7% and 11.83% gear options. Paired with our all-new portal axles with zero percent underdrive, this is the perfect mild setup for the average crawler. If even more underdrive in the rear is desired, an optional 12/23 tooth gear set (#42373) is available separately for an additional 36% overdrive from axle-to-axle alone!

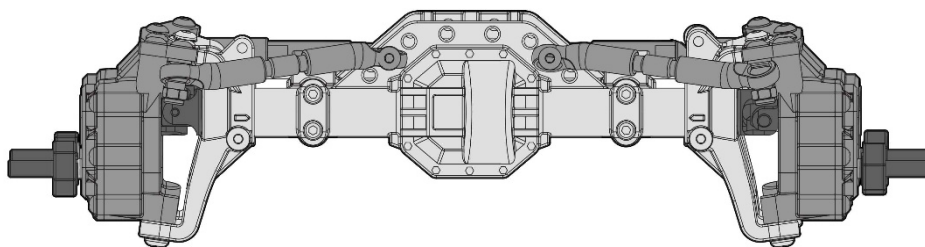
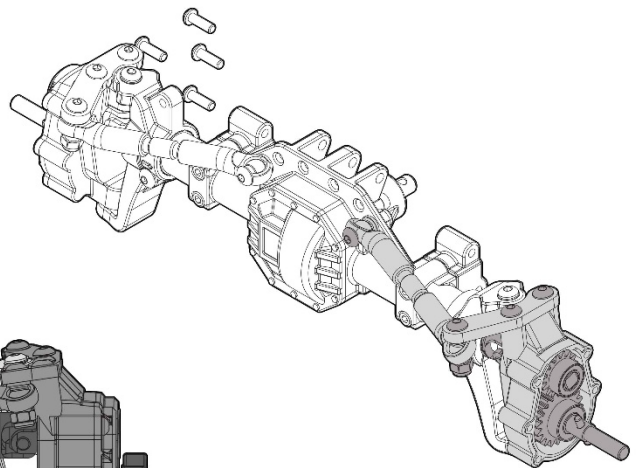

BODY FEATURES

All in the details. No trail truck would be complete without a detailed and realistic looking body. The RC10 Trail Truck is just that, with inspired styling from the classic Team Associated RC10.

The RC10 Trail Truck Portal Kit is heavily inspired by the classic look of the original Team Associated RC10 off-road buggy released in 1984.

This tribute trail truck kit features a full color decal sheet emulating the legendary Camel Yellow livery. The chassis comes complete with natural color plastic, satin silver wheels, and gold anodized aluminum accents.



The RC10 Trail Truck body is made from high-strength polycarbonate and comes clear so you can paint it the traditional Camel Yellow or the color of your choice. This body was designed for both looks and function, featuring a single-piece design with injection-molded roof rack, bumpers, mirrors, and polycarbonate inner fenders.

Out of the box, the RC10 Trail Truck Portal kit is ready to tackle the elements; just build it and go – your journey begins here!

OFFICIALLY LICENSED WHEELS AND TIRES:

Gripping the trail is a set of officially licensed General Grabber™ X3 tires molded in a high-performance, soft compound rubber.

The General Grabber™ X3 tires are mounted on officially licensed satin silver Method 701 Trail Series beadlock wheels.

The combination of industry leading General Tires™ and Method Wheels make the Enduro RC10 Trail Truck look and perform great.



FEATURES

- NEW high-clearance portal axles
- CMS (Chassis Mounted Servo)
- Adjustable front track bar
- Universal front drive axles
- Gold colored stamped steel frame rails
- 12mm wheel hexes
- Adjustable front bumper mount
- Two battery boxes
- Gold anodized aluminum motor plate
- Adjustable body posts
- Optimized ball cups for more fluid axle articulation
- Adjustable rear shock tower mount positions
- Telescopic driveshafts front and rear
- Extruded aluminum driveshaft splines
- Splined front axle with adjustable caster
- Metal gears throughout axles
- Increased inner axle input bearing
- Machined steel top shaft
- Steel servo horn
- Heavy-duty 5mm diameter steel links
- Metal ball bearings included

ADDITIONAL FEATURES:

- RC10 Trail Truck body thermoformed in high-strength polycarbonate
- Polycarbonate inner fenders
- Single-piece body with roof rack
- Clear windows
- Adjustable injection-molded front and rear bumpers
- Realistic styling
- Licensed 1.9"x4.65" General Grabber™ X3 tires
- Licensed 1.9" Method 701 Trail Series beadlock wheels

SPECS

Scale	1:10
Type	Off-Road
Power	Electric
Length	462mm (18.18")
Width	236mm (9.29")
Weight	Varies*
Wheelbase	325mm (12.8")
Chassis Material	Stamped Steel
Suspension	3-Link Front / 4-Link Rear
Internal Gear Ratio	Varies
Drivetrain	4WD
Tire	1.9" General Grabber™ A/T X
Speed	Varies
Gear Pitch	48 Pitch
Wheel size	1.9" Method Beadlocks
Build type	Kit
Body	RC10 Trail Truck
Ball bearings	24 Metal Ball Bearings
Shock type	Threaded, Aluminum Shock Bodies
Experience Level	Beginner to Advanced
Recommended Environment	Mother Earth

NOT INCLUDED:

Speed Control, Radio, Servo, Motor or Engine, Battery, Charger, Paint for body

CATALOG INFORMATION

UPC	Part No.	Description	MSRP	MAP	Pieces Per Case	Origin	Available
784695401372	40137	RC10 Trail Truck, Portal Kit	\$661.99	\$449.99	4	TW	Aug

Download all zipped photos here: [https://www.rc10.com/RC10TrailTruckImages/ \(725KB\)](https://www.rc10.com/RC10TrailTruckImages/ (725KB)). Link is active for 30 days.



21062 Bake Pkwy
Lake Forest CA 92630
www.AssociatedElectrics.com

