

RC10 RETRO 80'S

1:10 OFF ROAD RACING
ULTRA FOX



TEAM ASSOCIATED



1:10 Scale 2WD Electric Off Road Competition Buggy Kit Manual

#6051 RC10 Ultra Fox Retro 80's Kit



CHAMPIONS *by* DESIGN

AssociatedElectrics.com



:: Introduction

Thank you for purchasing this Team Associated product. This assembly manual contains instructions and tips for building and maintaining your new Kit. Please take a moment to read through this manual to help familiarize yourself with these steps. We are continually changing and improving our designs; therefore, actual parts may appear slightly different than in the illustrations. New parts will be noted on supplementary sheets located in the appropriate parts bags. Check each bag for these sheets before you start to build.

:: KIT Features

- 80's Retro themed RC10 Classic
- Black anodized 6061-T6 aluminum monocoque Tub chassis
- New molded side guards
- Black anodized nose plate and motor plate
- New molded front bumper
- New molded rear bulkhead system
- Hardened rear dog bones
- Exclusive metallic gold anodized front mono-shock system
- Long travel, fluid-filled anodized aluminum rear coil-over shocks
- Legendary 6 gear transmission
- Exceptional ground clearance with low center of gravity
- Classic front and rear tires with metallic gold 3-piece racing wheels
- Clear Viper Body with Classic wing and Clear Driver
- New front mono-shock tower
- Full metal ball bearings
- Fits 6-cell NiMH and 2S LiPo battery packs
- Independent rear suspension
- Front anti-roll bar set

:: Additional

Your new RC10 comes as a kit. There are some items you will need to complete your kit (refer to website for suggestions):

- 2-3 Channel radio system
- Steering Servo
- 2S (7.4V) LiPo battery
- 540 Motor (Brushless system recommended)
- Electronic Speed Control (ESC)
- Polycarbonate paint for body
- Compatible Battery Charger

Tools included:

- (0.035", .050", 1/16", 3/32") Shock building tool.

:: Other Helpful Items

- Silicone Shock Fluid (Refer to website for complete listings)
- Tire Adhesive (AE #1697)
- Shock Pliers (AE #1681)
- Wire Cutters / Hobby Knife
- Body Scissors (AE #1737)
- Green Slime shock lube (AE #1105)
- Needle Nose Pliers
- Reamer / Hole Punch (AE #1499)
- Calipers or a Precision Ruler
- Soldering Iron

Associated Electrics, Inc.
21062 Bake Parkway
Lake Forest, CA 92630



Customer Service
Tel: 949.544.7500
Fax: 949.544.7501

:: Hardware - 1:1 Scale View

Cap Head (shcs)

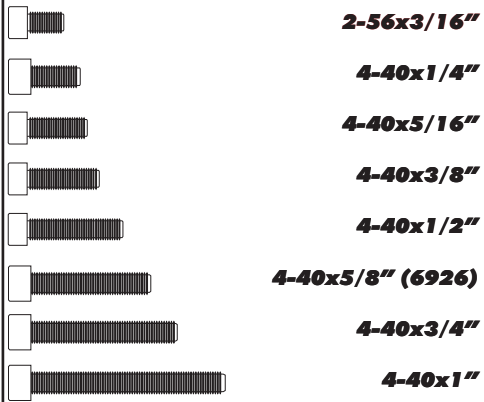

Flat Head (fhcs)



Button Head (bhcs)

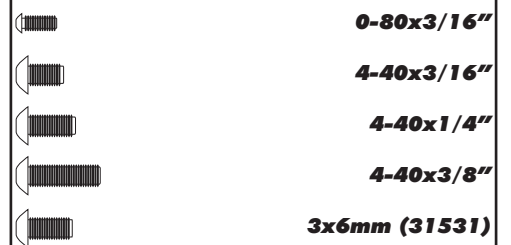

Shims and Washers

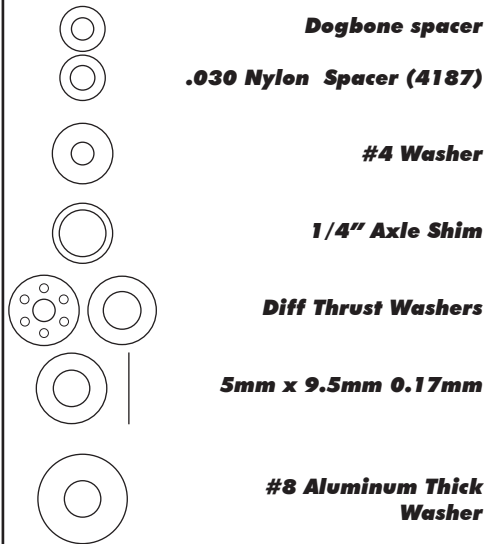

Nuts (lock/plain)

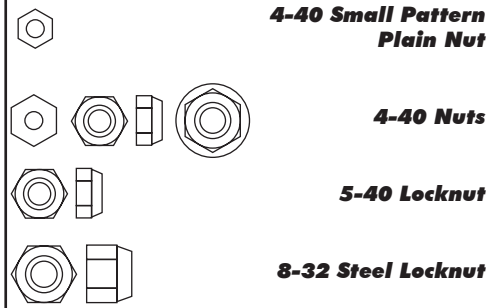

Set Screws



Diff Balls



Clips



Bearings

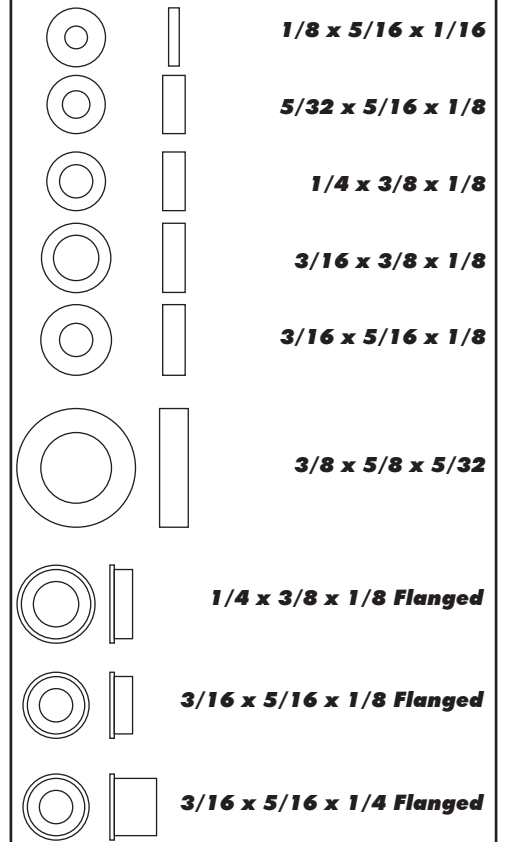

Notes:

:: Table of Contents

1..... Cover	12.....Rear Suspension and Side Roll Cage Build(Bag E)
2..... Introduction	12.....Turnbuckles Build (Bag F)
3.....1:1 Hardware "Fold Out"	14.....Sway Bar Installation (Bag G)
4..... Table of Contents	14.....Shocks Build (Bag G)
5.....Nose Plate / Steering Build (Bag A)	16Chassis Build (Bag H)
5.....Front Suspension Build (Bag B)	17.....Steering Servo Build (Bag I)
7.....Transmission Build (Bag C)	18.....Wheels,Tires and Body install (Bag J)
10.....Rear Bulkhead Build (Bag D)	22.....Back Cover

:: Notes

This symbol indicates a special note or instruction in the manual.



There is a 1:1 hardware foldout page in the front of the manual. To check the size of a part, line up your hardware with the correct drawing until you find the exact size.

Associated Electrics, Inc.
21062 Bake Parkway
Lake Forest, CA 92630



Customer Service
Tel: 949.544.7500
Fax: 949.544.7501

:: Nose Plate / Steering Build - Bag A - Step 1

!
Washers are used to adjust to your preferred body height.

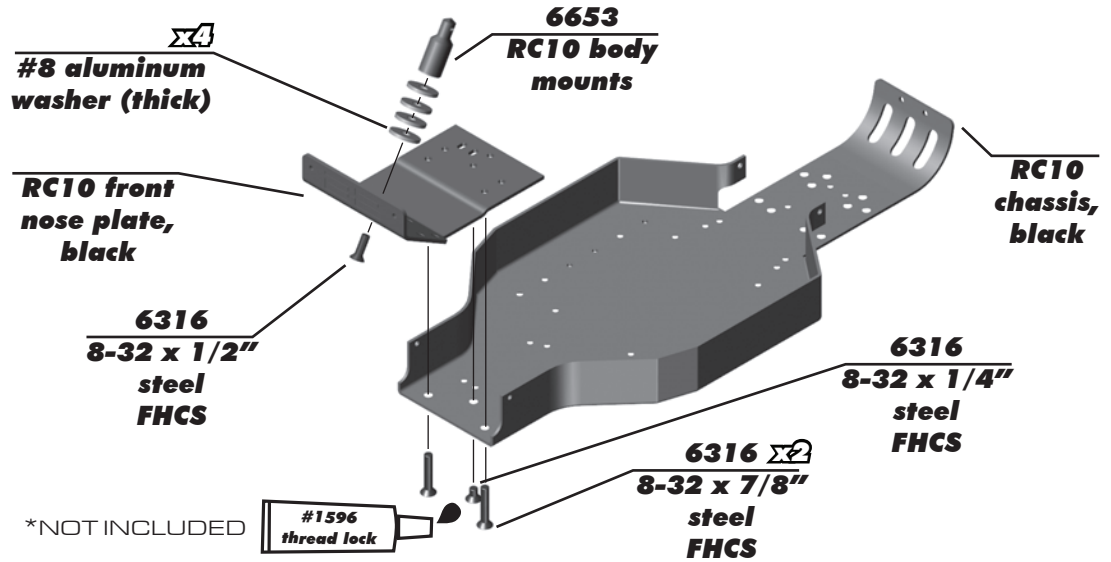

:: Nose Plate / Steering Build - Bag A - Step 2

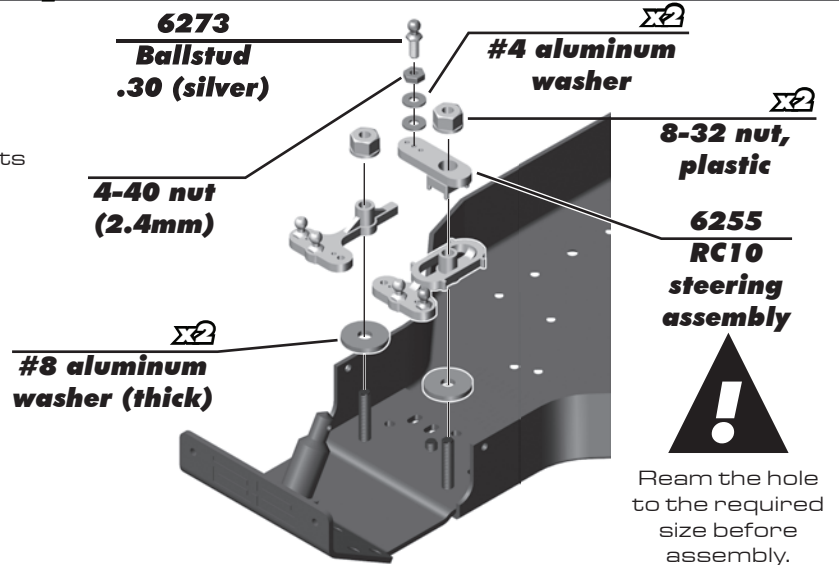
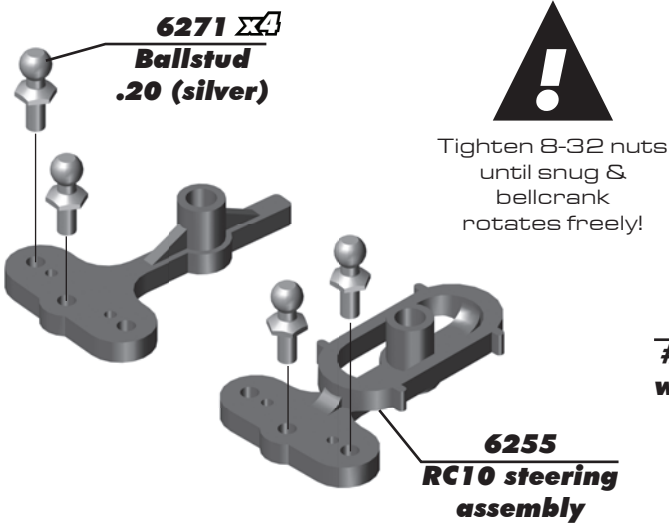

:: Front Suspension Build - Bag B - Step 1

LEFT

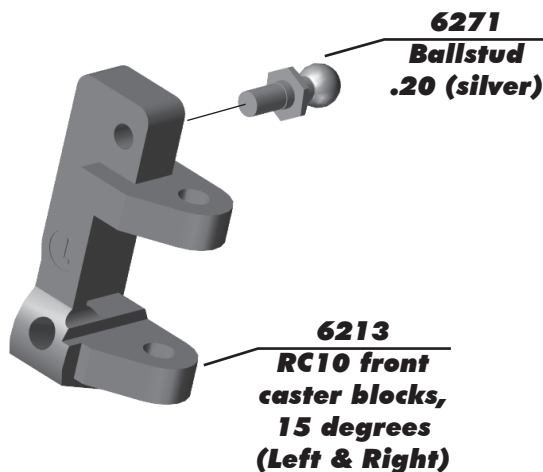

Build left and right sides!

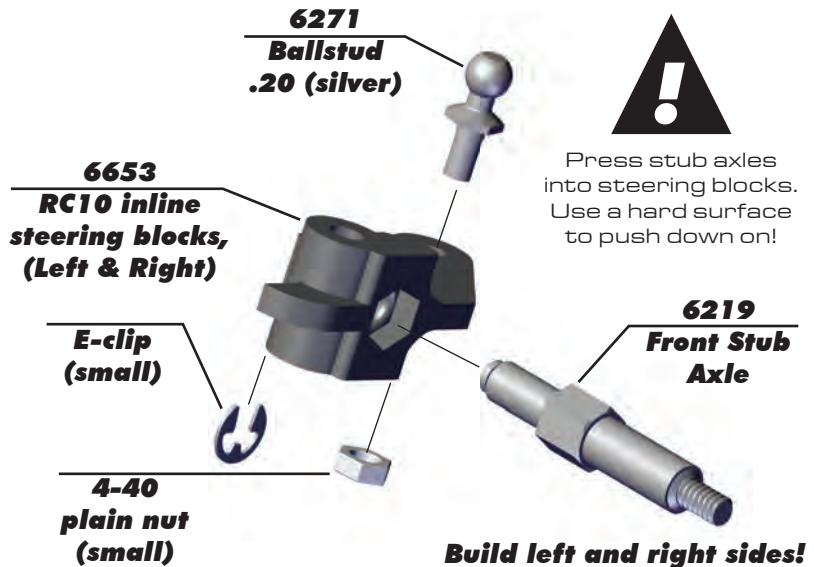

Build left and right sides!

:: Front Suspension Build - Bag B - Step 2

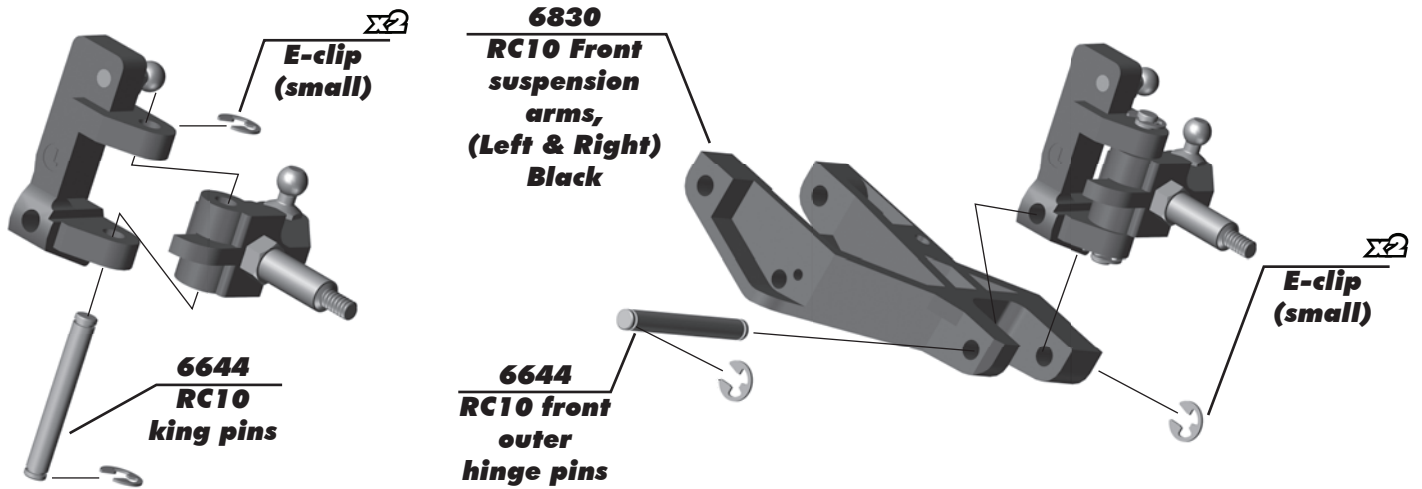

Build left and right sides!

:: Front Suspension Build - Bag B - Step 3

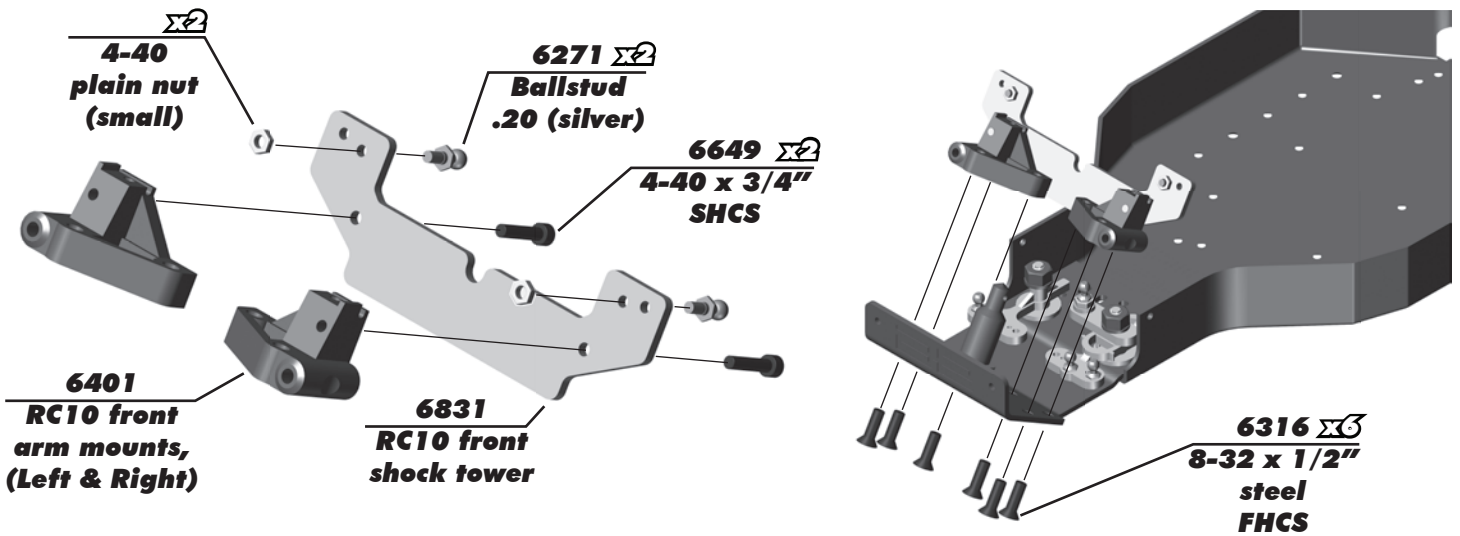

:: Front Suspension Build - Bag B - Step 4

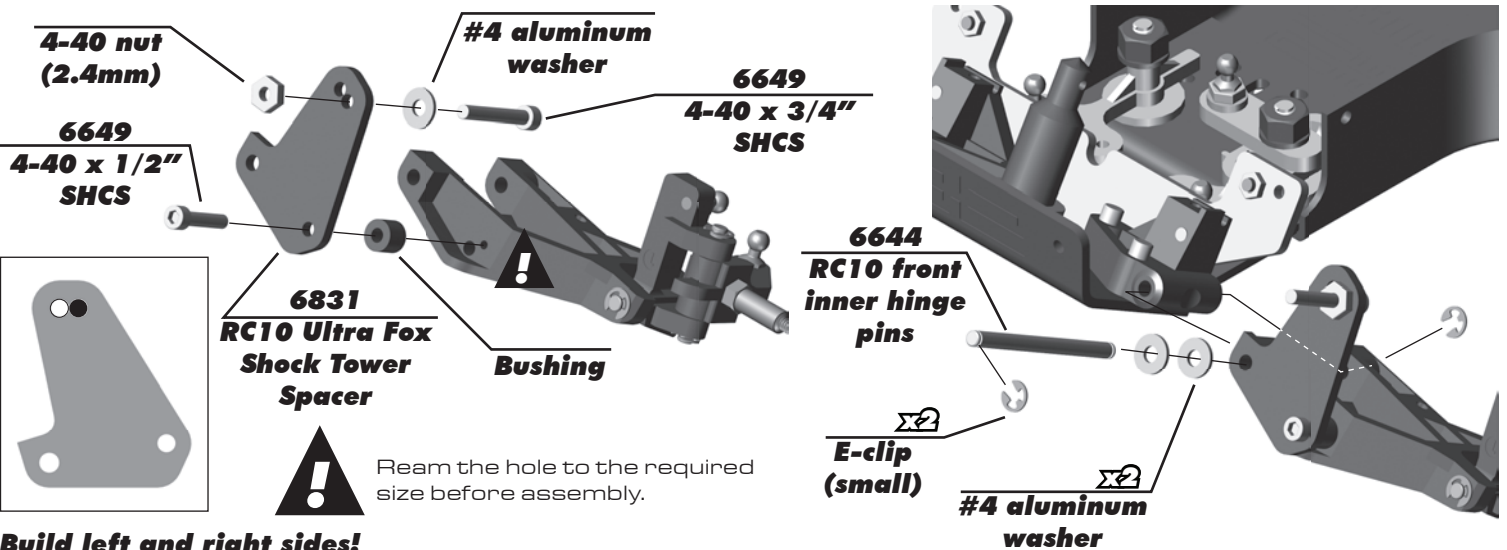

Build left and right sides!

:: Transmission Build - Bag C - Step 1

6833
Drive gear
pivot pin

!
Remove any burrs
if necessary with
hobby knife!

6833
Drive gear
pivot

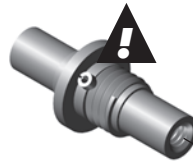

!
Key drive gear pin
into slot on spine
plate!

6833
Spine plate

#6833
Pivot nut

#1596
thread lock

:: Transmission Build - Bag C - Step 2

6833
Idler gear
pivot

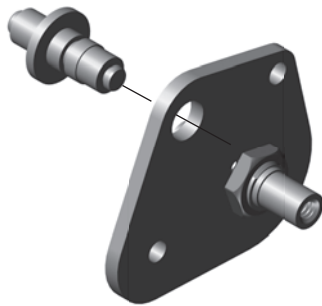

NOTE: Install washer [1]
before bowed e-clip [2]

6833
Bowed
E-clip

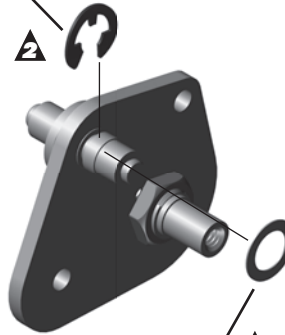

Washer
5mmx 0.17mm

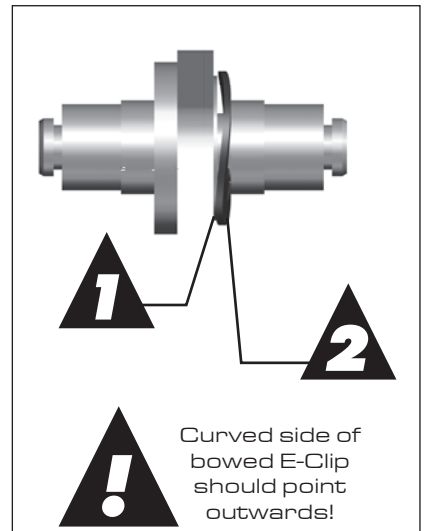

1

2

!
Curved side of
bowed E-Clip
should point
outwards!



Racer's Tip:
Use a small amount of
CA glue on idle pivot hole.

:: Transmission Build - Bag C - Step 3

6834
Flanged
bearing

6834
RC10 axle
drive Gear

!
Snap internal
retaining clip
into groove
with internal
snap ring
pliers!

6834
drive
bearing

6834
Snap ring

!
A little in-out
play is normal on
the outrives

#1596
thread lock

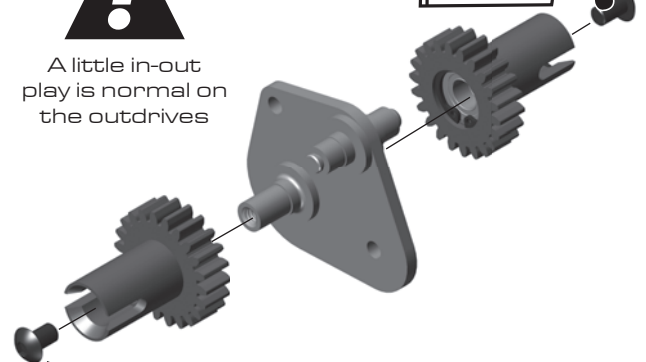

6649 
RC10 Screw set

Build 2

:: Transmission Build - Bag C - Step 4

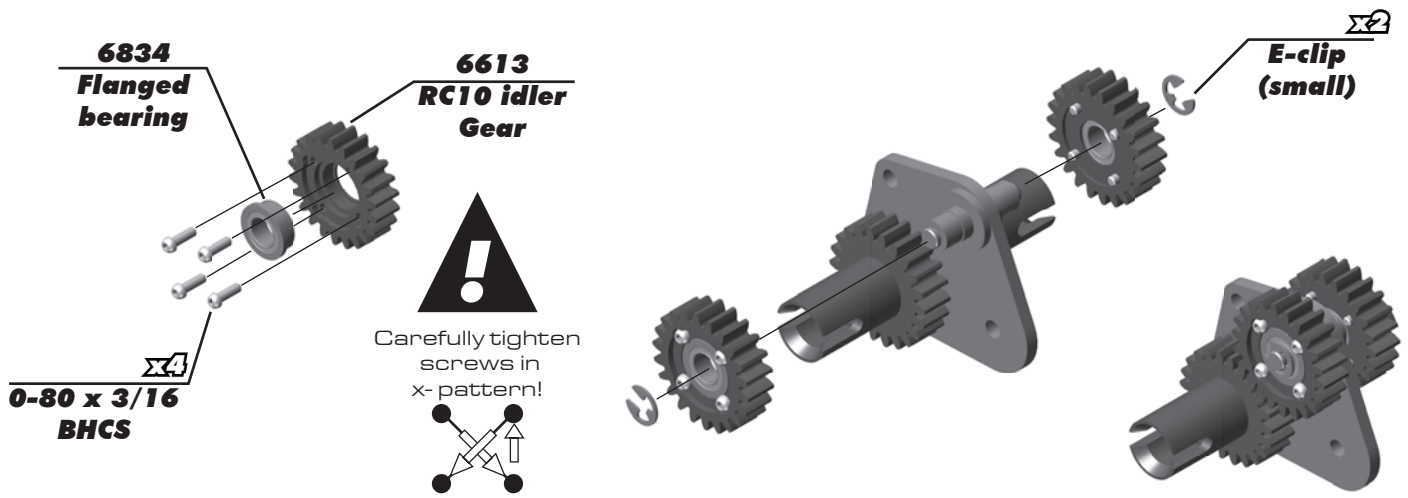

Build 2

:: Transmission Build - Bag C - Step 5

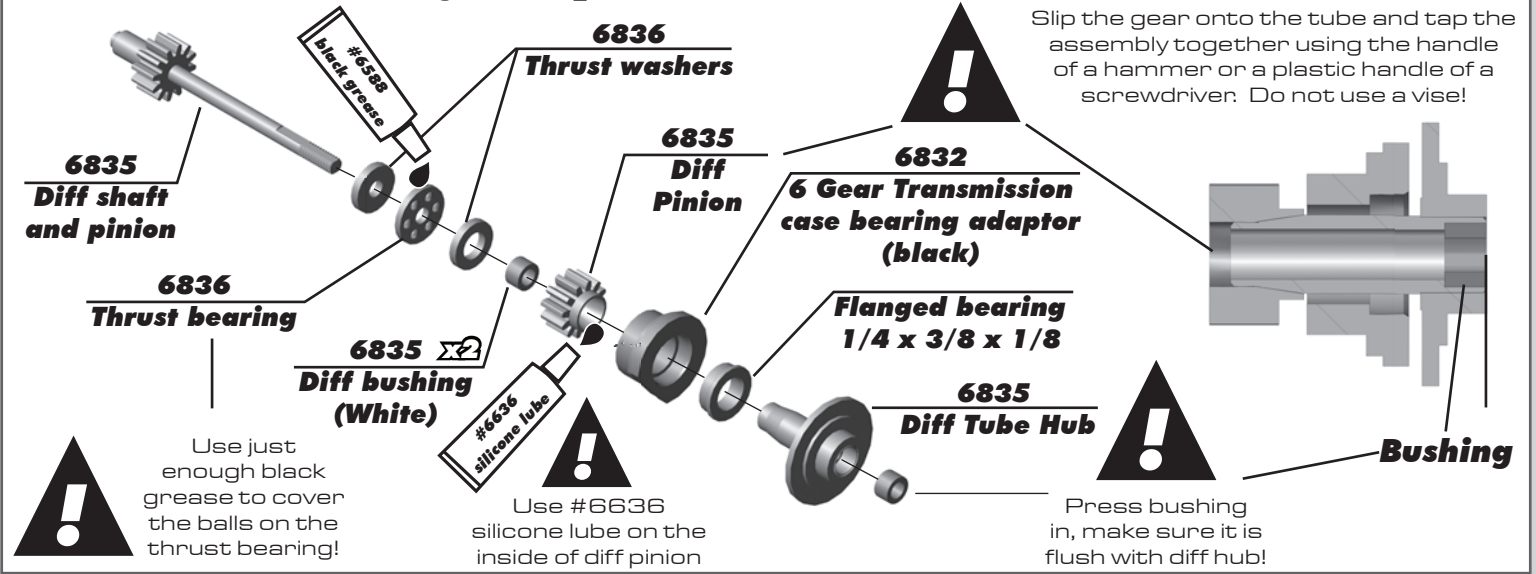

:: Transmission Build - Bag C - Step 6

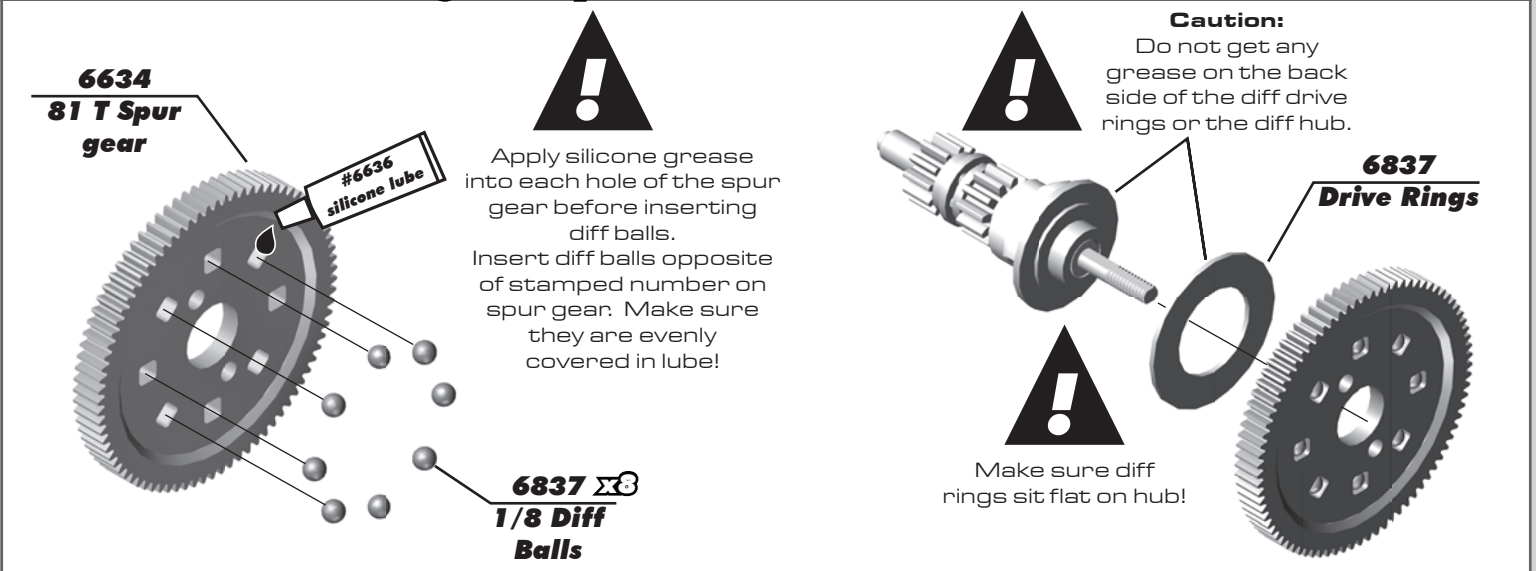

:: Transmission Build - Bag C - Step 7

Caution:
Do not get any grease on the back side of the diff drive rings or the outer hub.

6837 Drive Rings

6835 Outer Hub

6835 Diff Spring

6835 Lock nut

Caution:
Make sure diff rings sit flat on hub!

Caution:
Tighten locknut until spring is fully compressed, then back out until lock nut is flush with shaft end. Adjust as necessary.

:: Transmission Build - Bag C - Step 8

6755 RC10 spare motor plate Black

6832 6 Gear Transmission Case Black

6832 Bearing adaptor Black

Flanged bearing 3/16 x 5/16 x 1/8

E-clip (small)

NOTE: Follow the steps

Caution:
Cutting a slot in the bearing adaptor will make e-clip installation easier!

:: Transmission Build - Bag C - Step 9

RC10 felt

RC10 felt seal

4-40 plain nut (small)

Caution:
Press nut all the way inside the transmission case.

:: Transmission Build - Bag C - Step 10

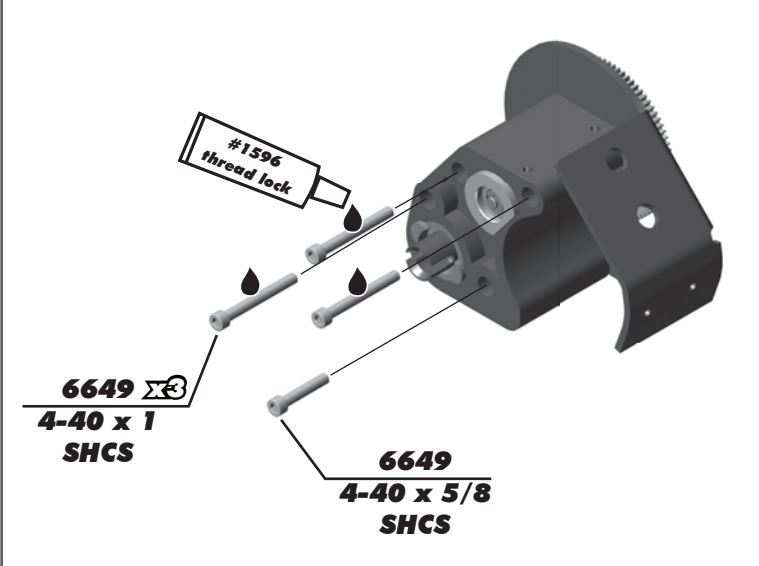

:: Rear Bulkhead Build - Bag D - Step 1

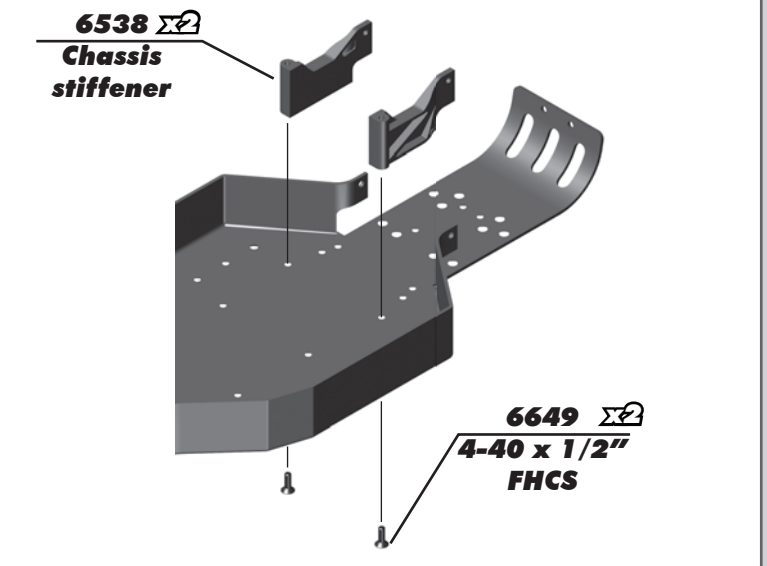

:: Rear Bulkhead Build - Bag D - Step 2

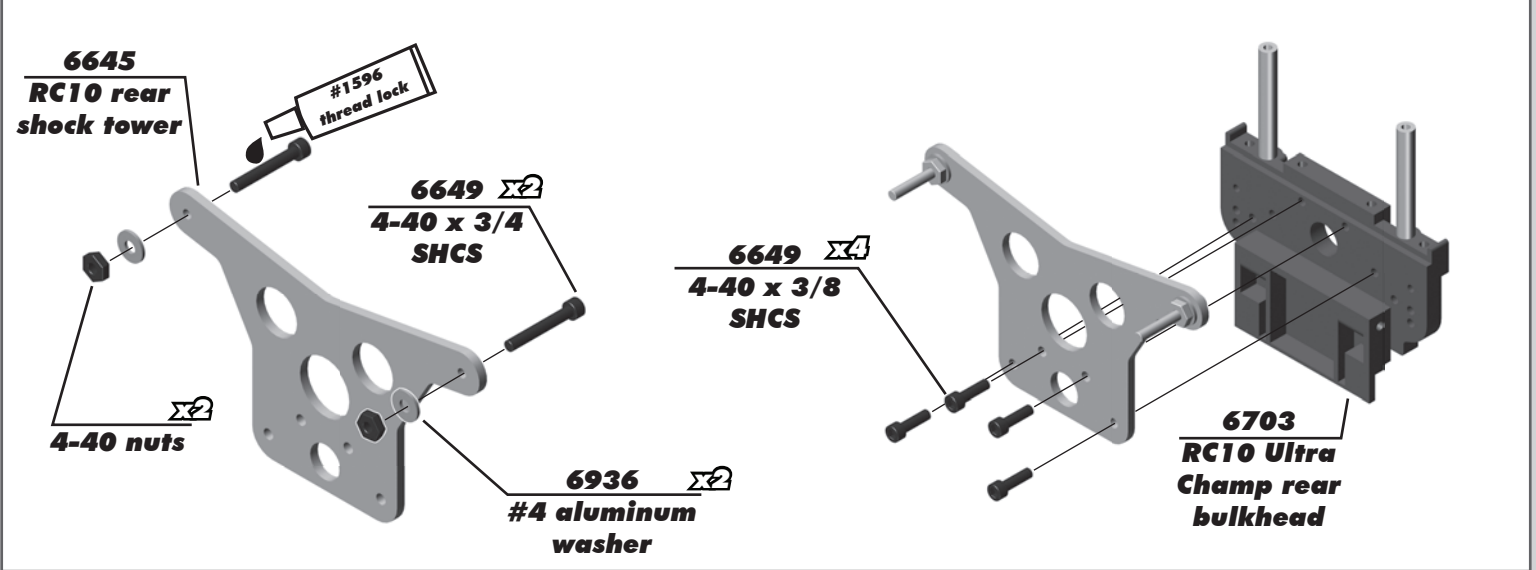

:: Rear Bulkhead Build - Bag D - Step 3

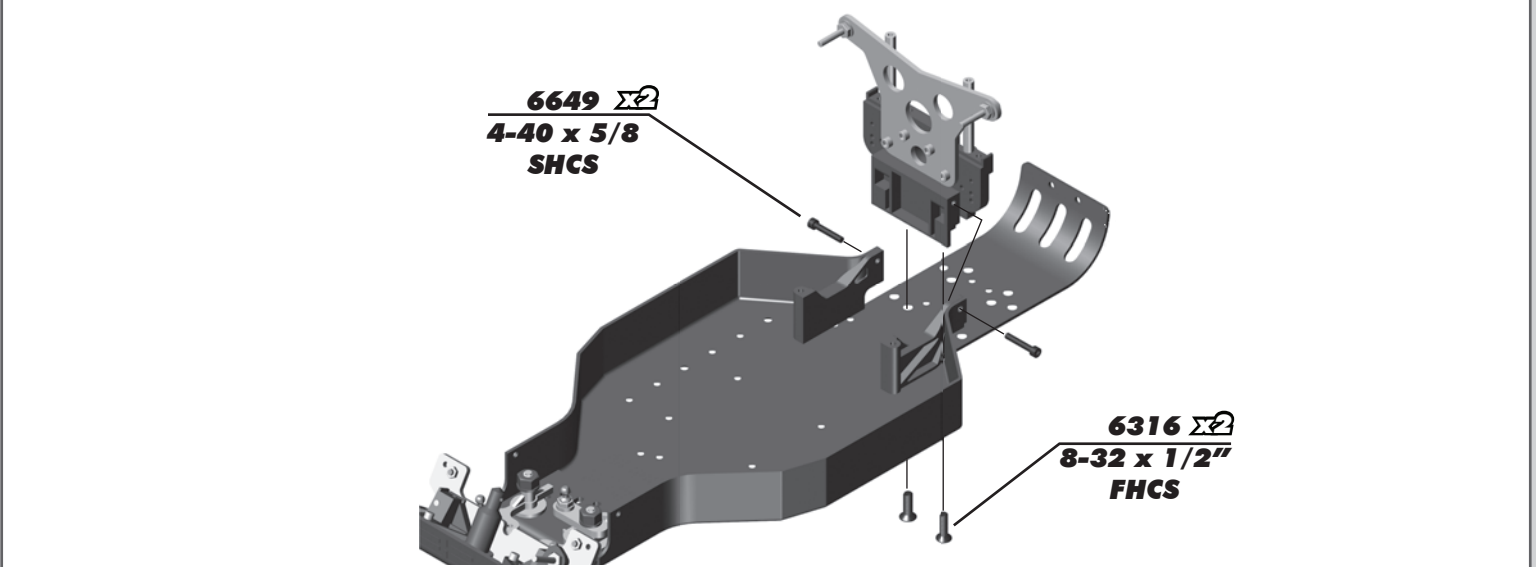

:: Rear Bulkhead Build - Bag D - Step 4



Note the orientation of the rear bulkhead cover (middle). It should be flush with the two side pieces along the dotted line as shown below.

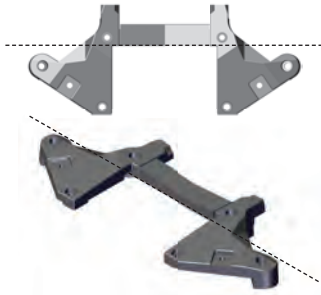

6706 $\Sigma 2$
RC10 Ultra Fox rear bulkhead cover (right and left)

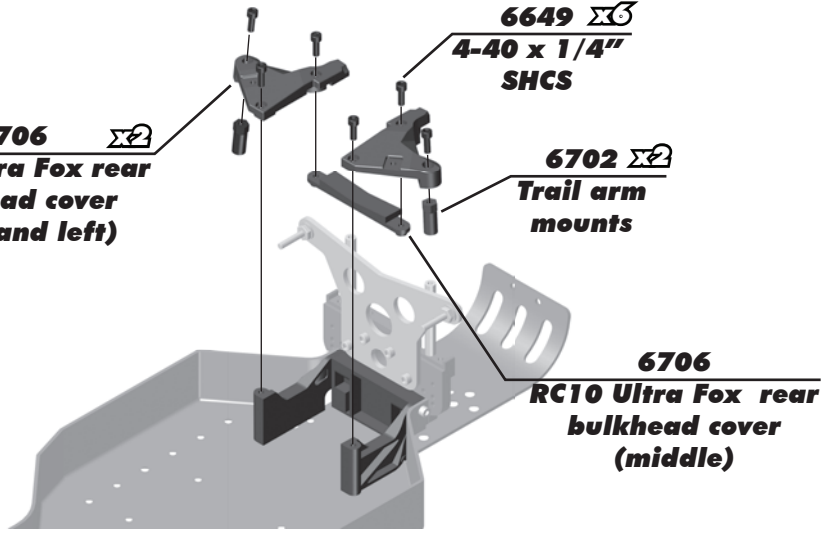

:: Rear Bulkhead Build - Bag D - Step 5

NOTE: Follow the steps

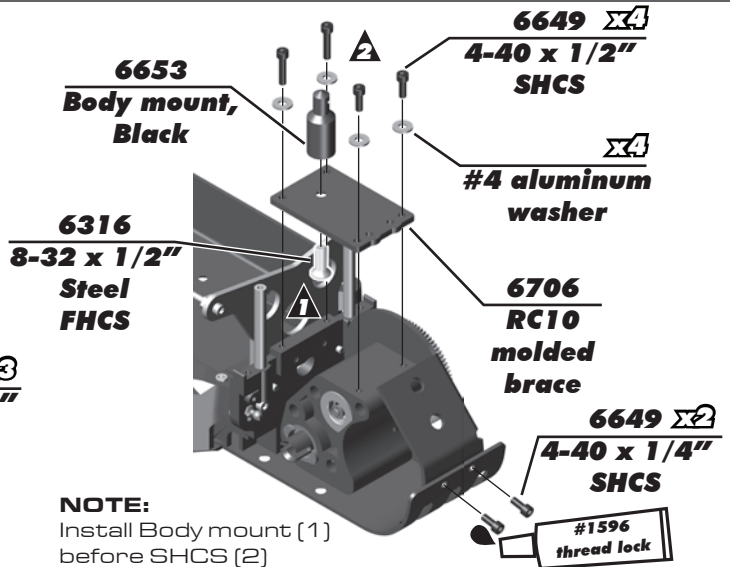
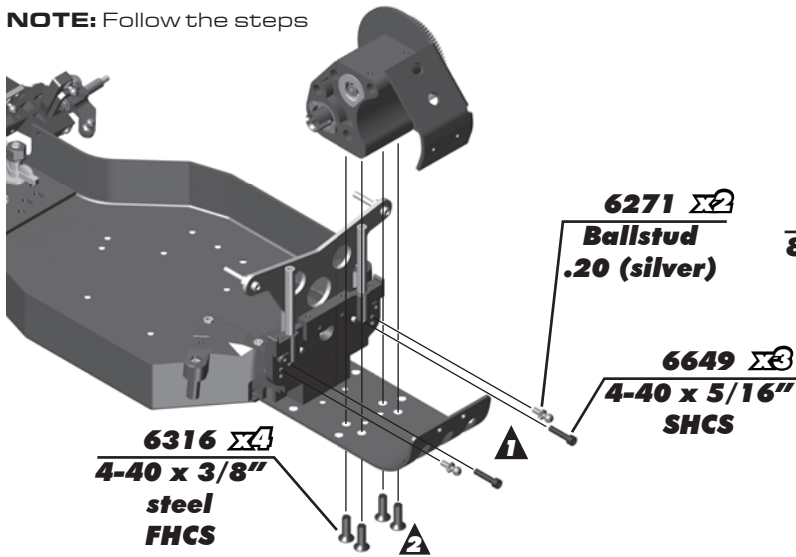

:: Rear Suspension and Side Roll Cage - Bag E - Step 1

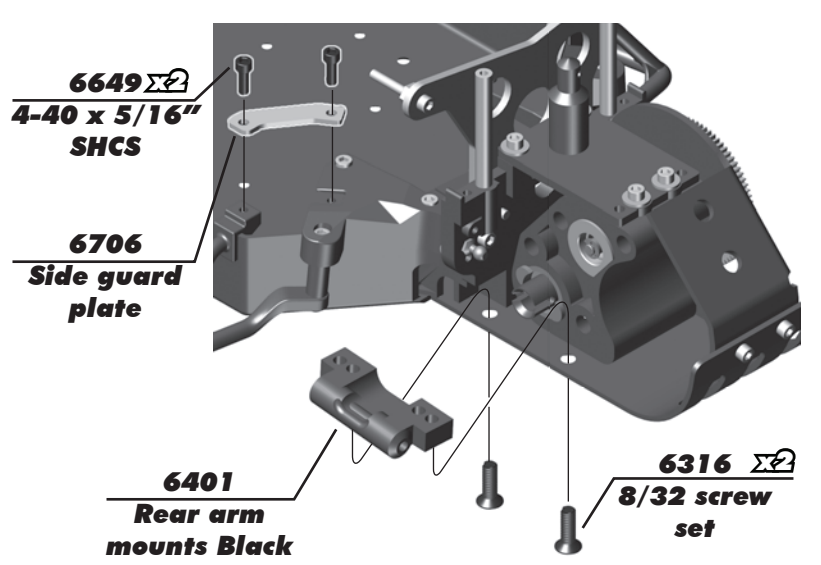
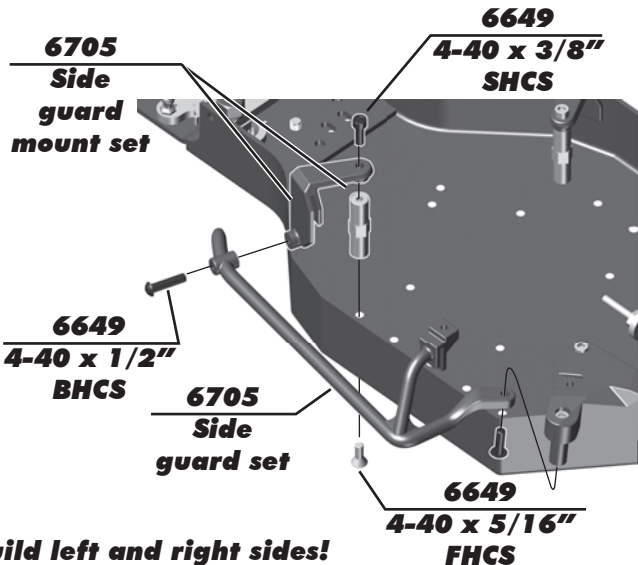

:: Rear Suspension and Side Roll Cage - Bag E - Step 2

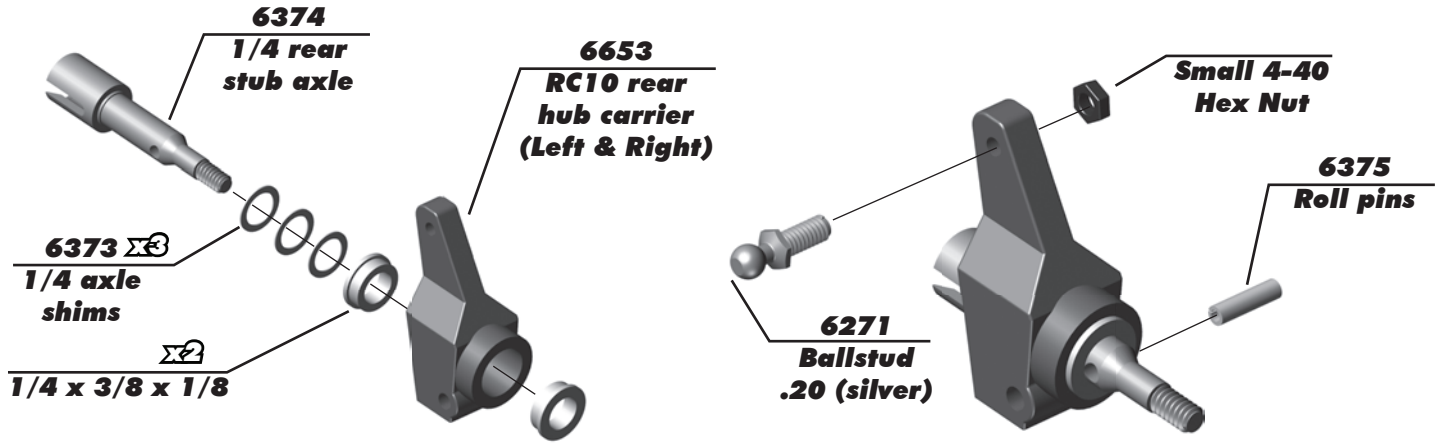

Build left and right sides!

Build left and right sides!

:: Rear Suspension and Side Roll Cage - Bag E - Step 3

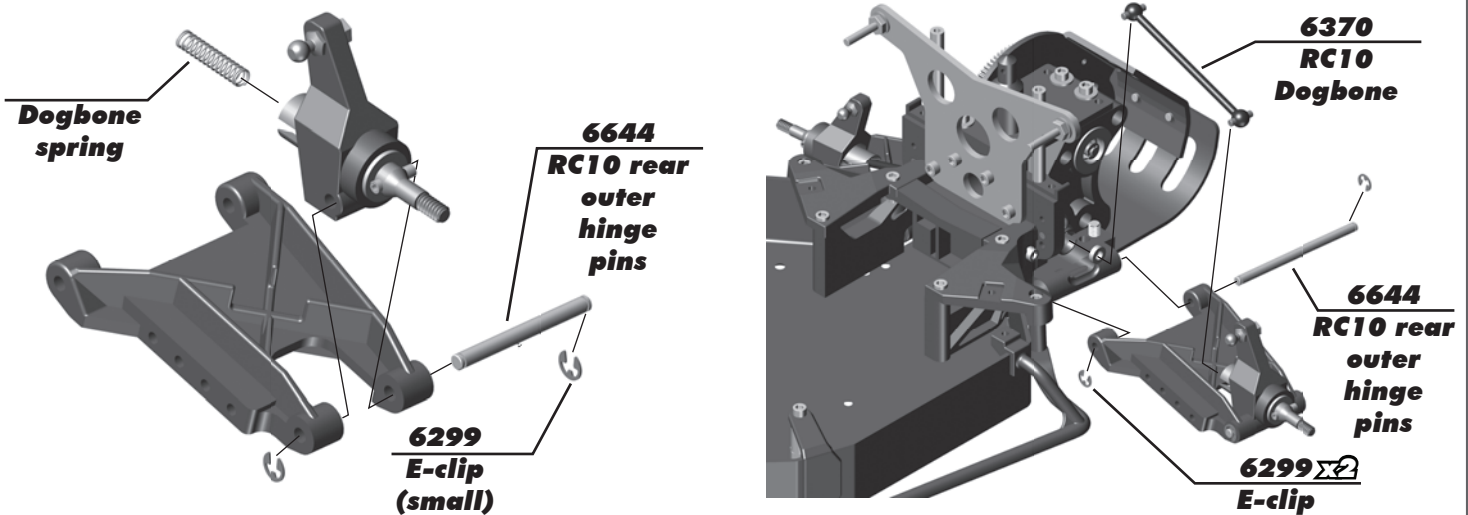

Build left and right sides!

Build left and right sides!

:: Turnbuckles Build - Bag F - Step 1

! Use a pair of pliers or wire cutters to carefully hold the turnbuckle while threading on ball cups.

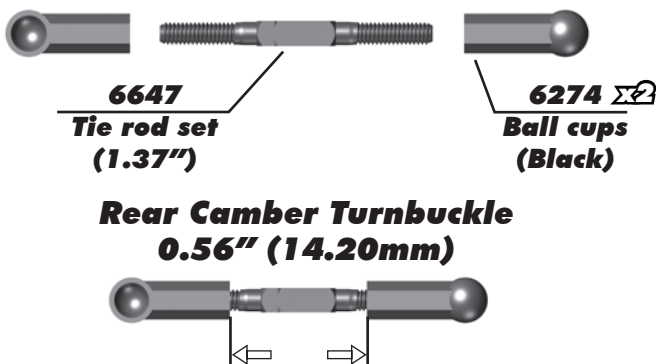

Build left and right sides!

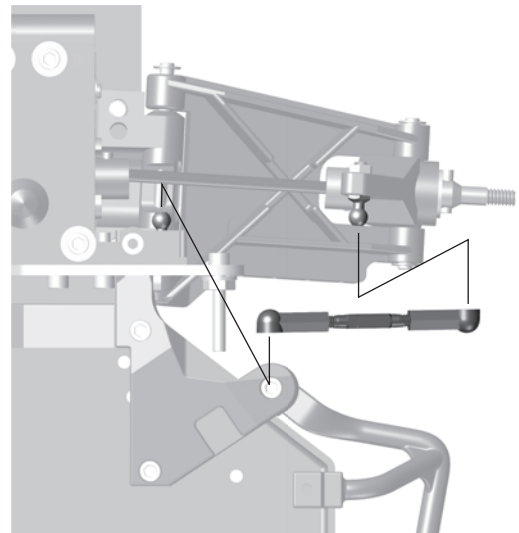

:: Turnbuckles Build - Bag F - Step 2

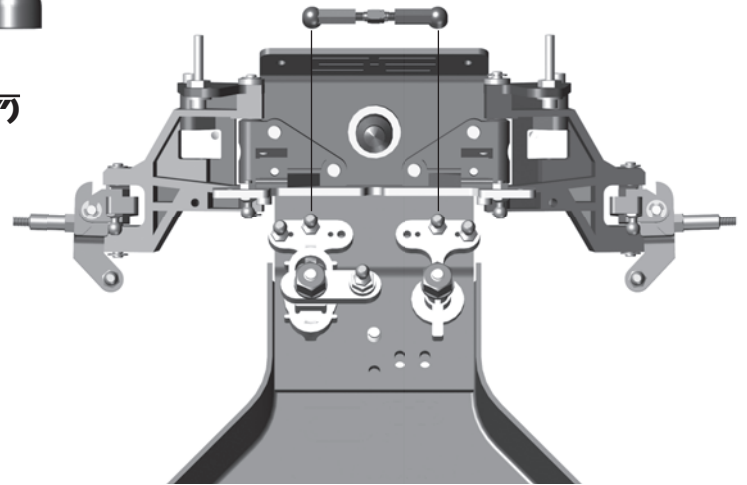
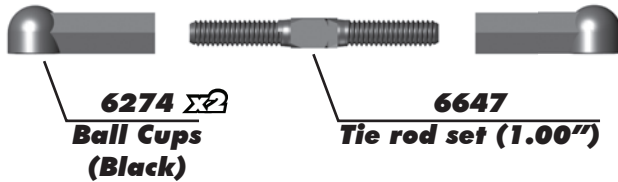

Orient the notch to the left throughout the car. It indicates which end has the left hand threads!

**Steering Rack Turnbuckle
0.50" (12.50mm)**

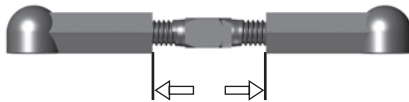

:: Turnbuckles Build - Bag F - Step 3

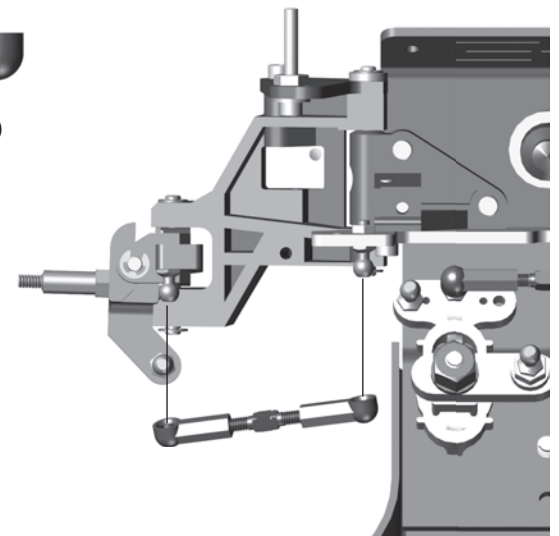
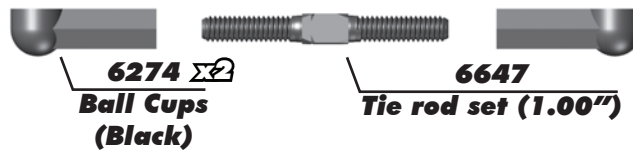

Orient the notch to the left throughout the car. It indicates which end has the left hand threads!

**Front Camber Turnbuckle
0.59" (15.00mm)**

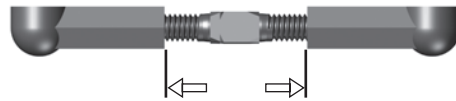

Recommended turnbuckle lengths are approximate. Final recommended settings = 0 degree Front Toe in and -2 Degree Camber Front and Rear.

Build left and right sides!

:: Turnbuckles Build - Bag F - Step 4

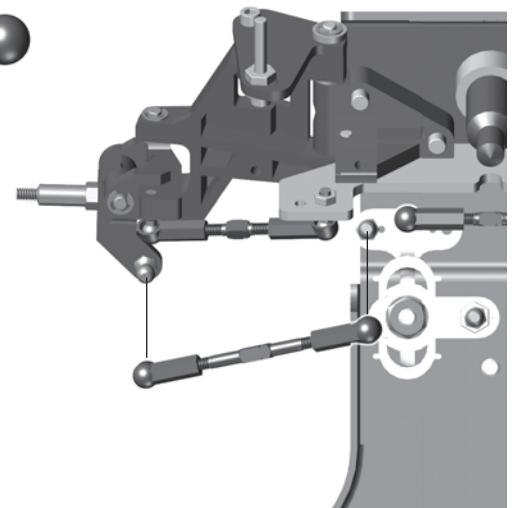
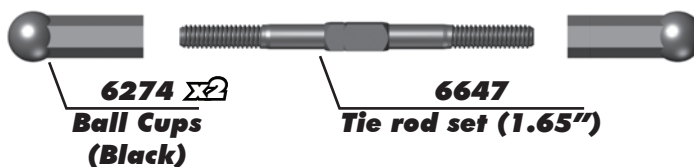

Orient the notch to the left throughout the car. It indicates which end has the left hand threads!

**Steering Turnbuckle
1.06" (27.00mm)**



Recommended turnbuckle lengths are approximate. Final recommended settings = 0 degree Front Toe in and -2 Degree Camber Front and Rear.

Build left and right sides!

:: Sway Bar Installation - Bag G - Step 1

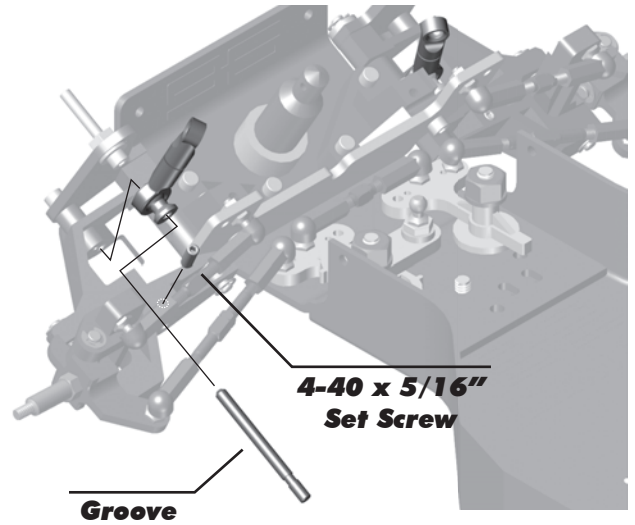
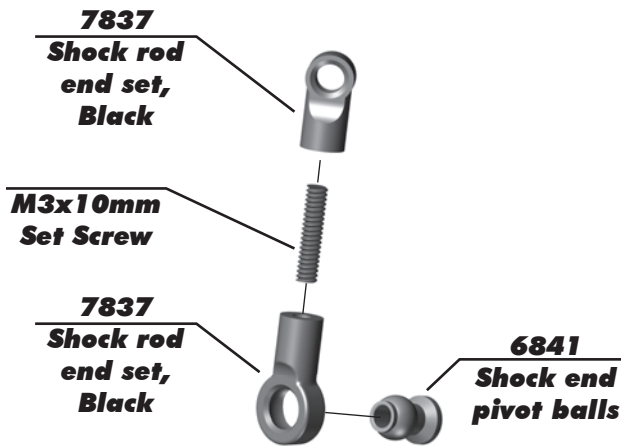

Build left and right sides!

:: Sway Bar Installation G - Step 2

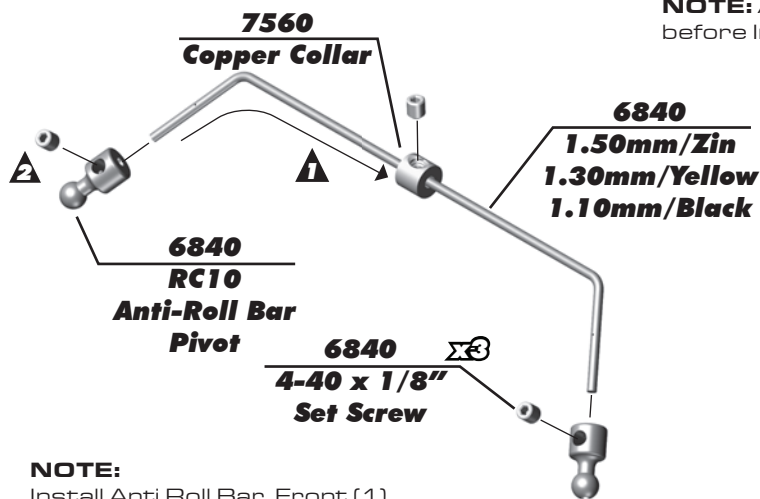

NOTE: Anti-Roll Bar_Pivot [1] before Install the screw and washer [2]

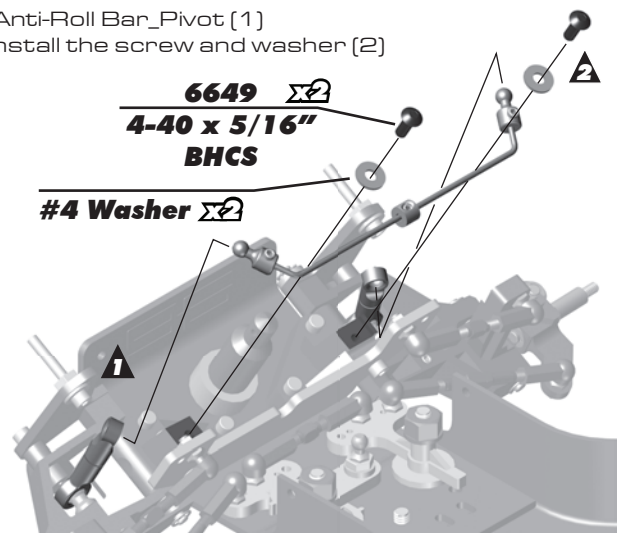

NOTE: Install Anti Roll Bar_Front [1] before Anti-Roll Bar_Pivot [2]

:: Shocks Build - Bag G - Step 1

Piston

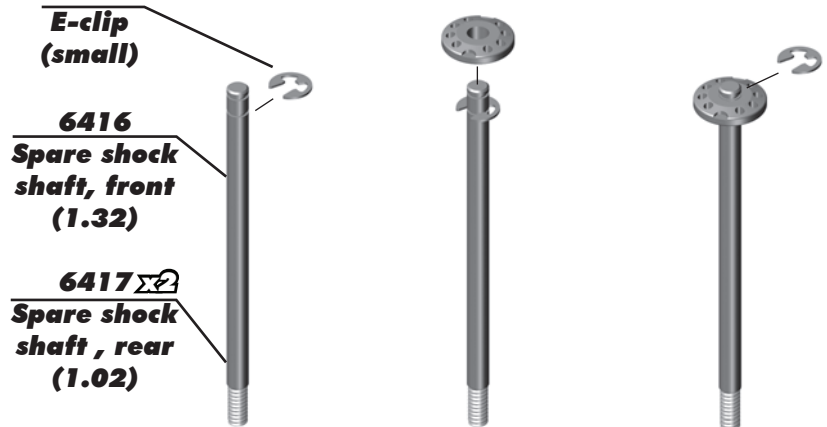
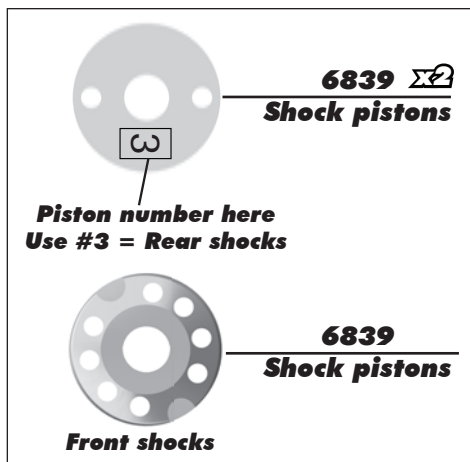

Build one front and two rear!

:: Shocks Build - Bag G - Step 2

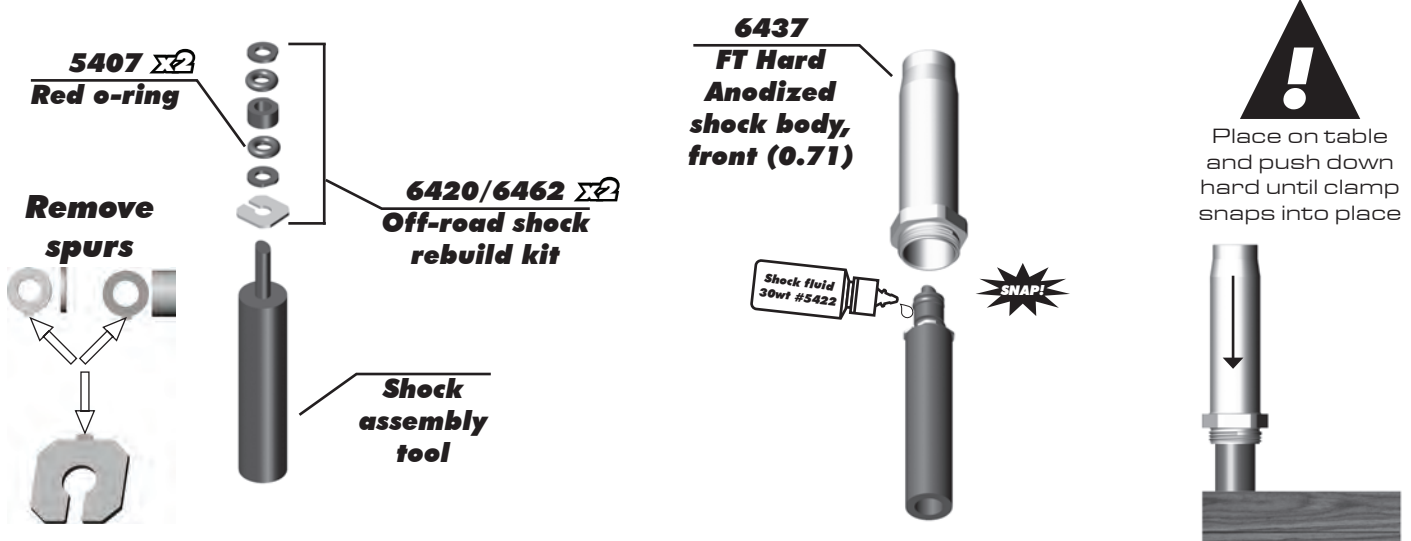

:: Shocks Build - Bag G - Step 3

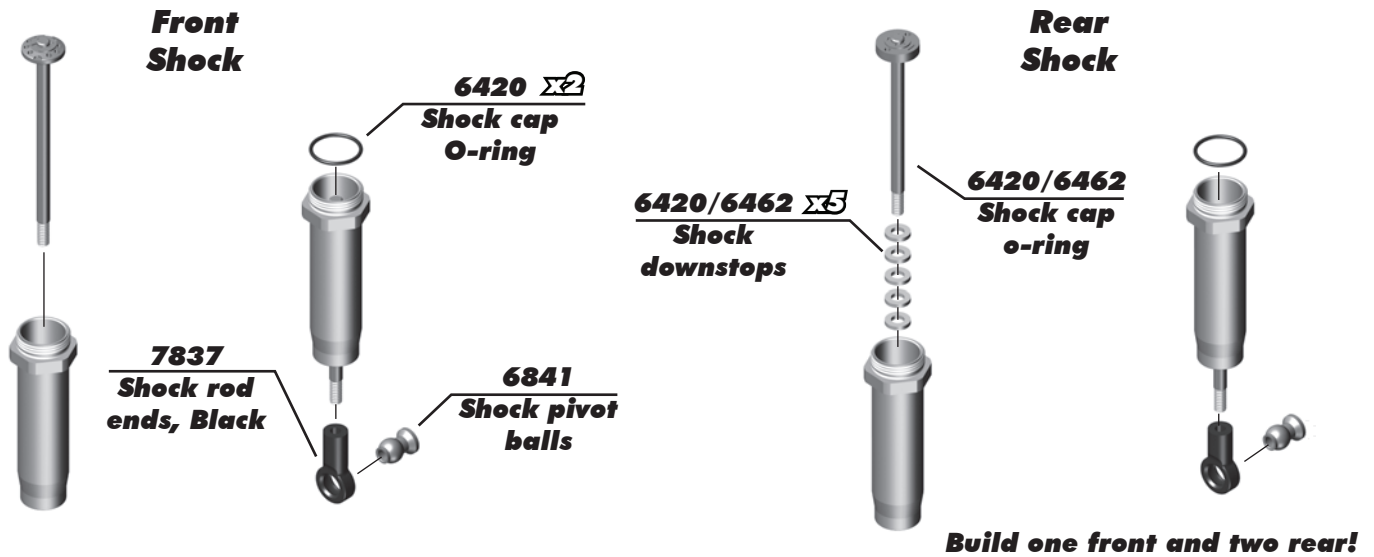

:: Shocks Build - Bag G - Step 4

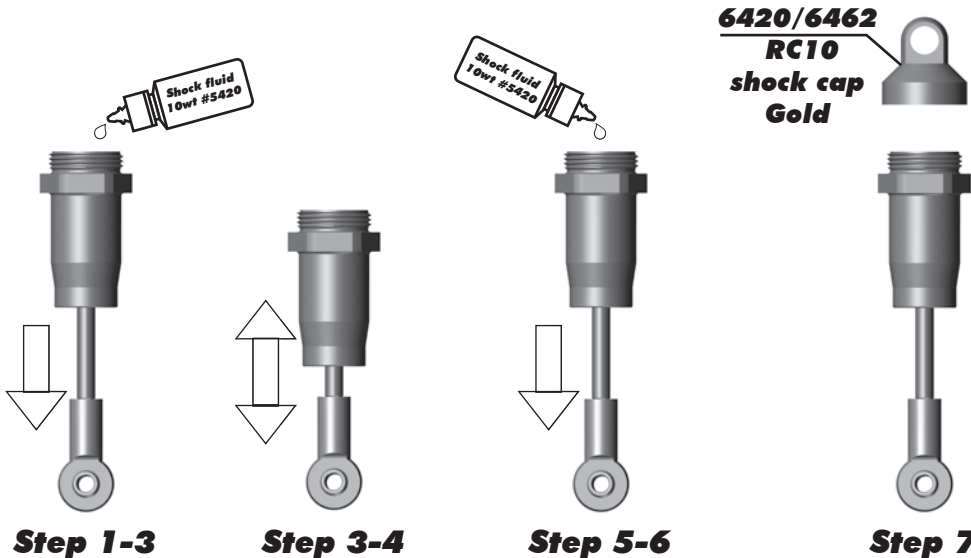

* Shock Bleeding Steps:

1. Pull shock shaft down.
2. Fill shock body 3/4 full with silicone fluid.
3. Slowly move the shock shaft up and down to remove air from under piston.
4. Wait for bubbles to come to surface.
5. Fill shock body to top with silicone fluid.
6. Place several drops of oil in the cap and on cap threads.
7. Install cap and tighten completely.
8. Slowly compress shaft all the way to the top. If there is pressure at the top of the stroke, there is too much oil. You must bleed it out.
9. Slowly pull shaft down.
10. Unscrew the cap 3/4 turn and tilt the shock at a slight angle.
11. Slowly compress the shaft to push out excess oil and air. You should see bubbles coming out from under the cap.
12. With the shaft compressed, tighten the cap and re-check for pressure at the top of the stroke. If there is still pressure, repeat steps 9 thru 11.

:: Shocks Build - Bag G - Step 5

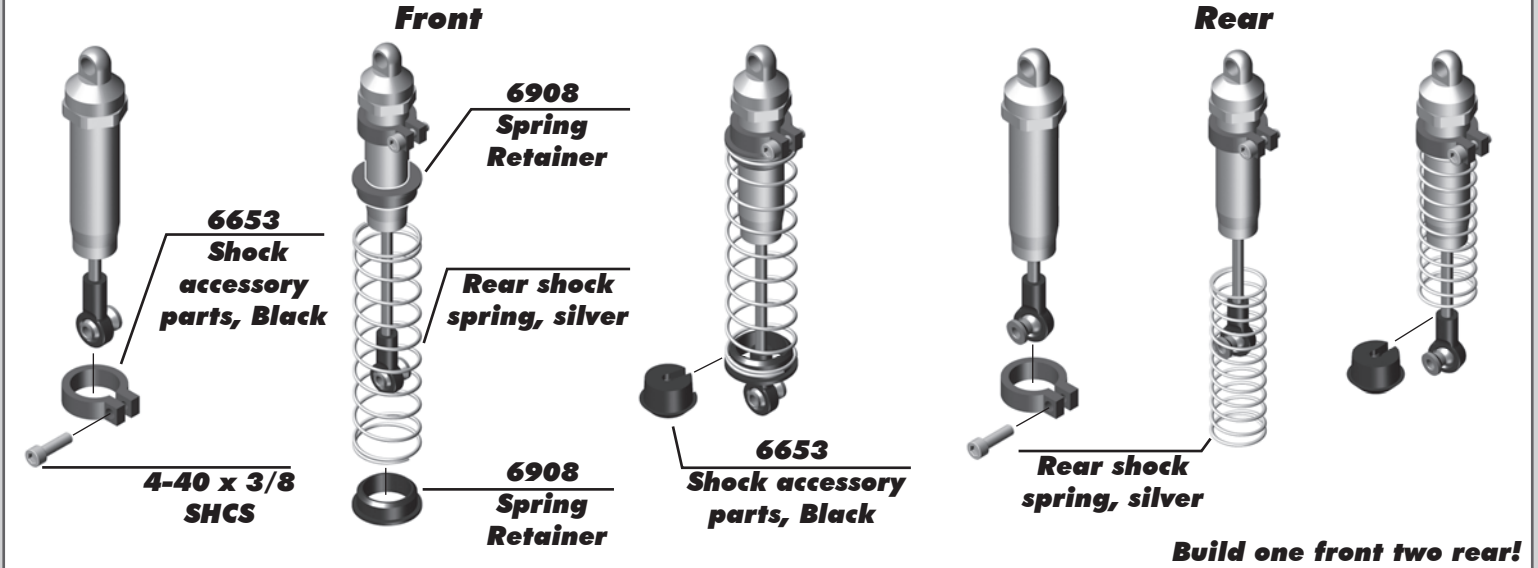

:: Shocks Build - Bag G - Step 6

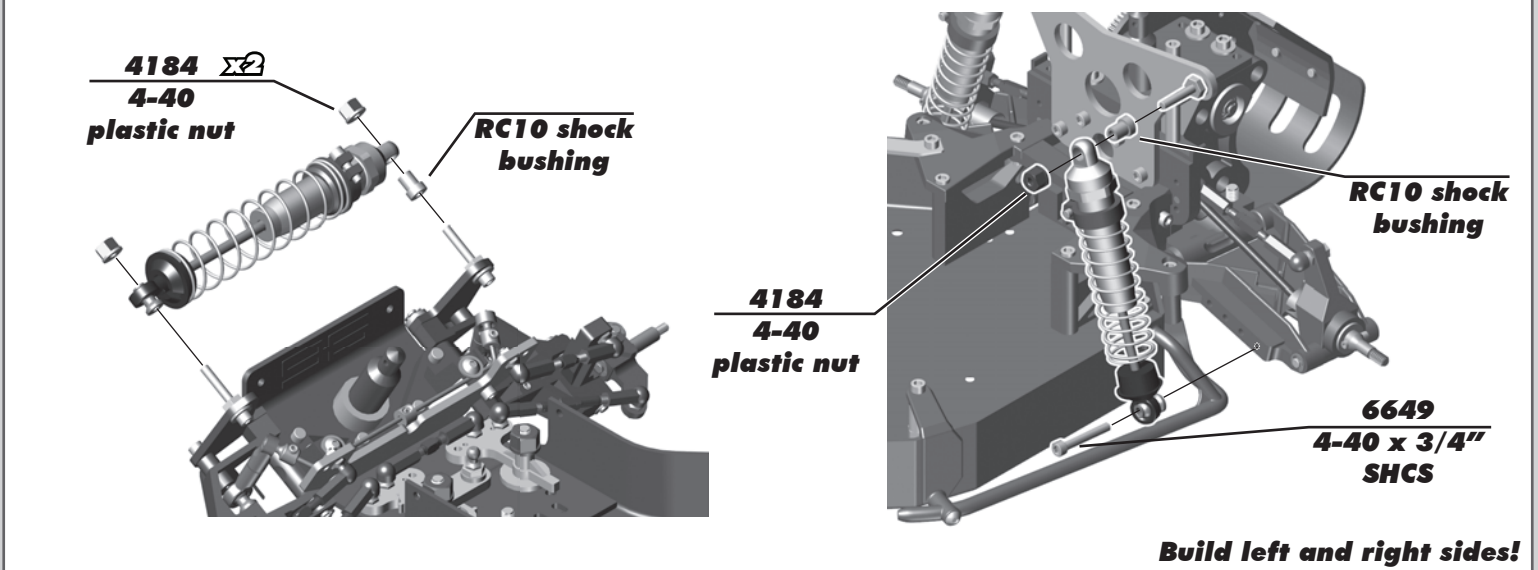

:: Chassis Build - Bag H - Step 1

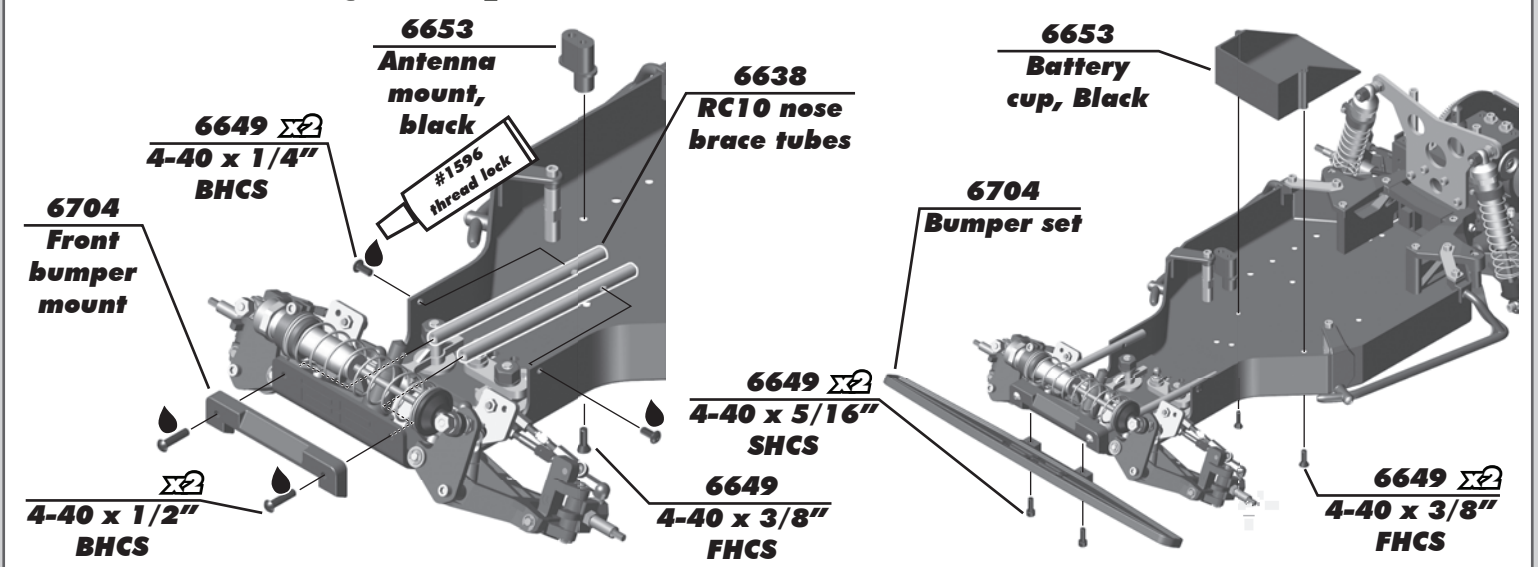

:: Chassis Build - Bag H - Step 2

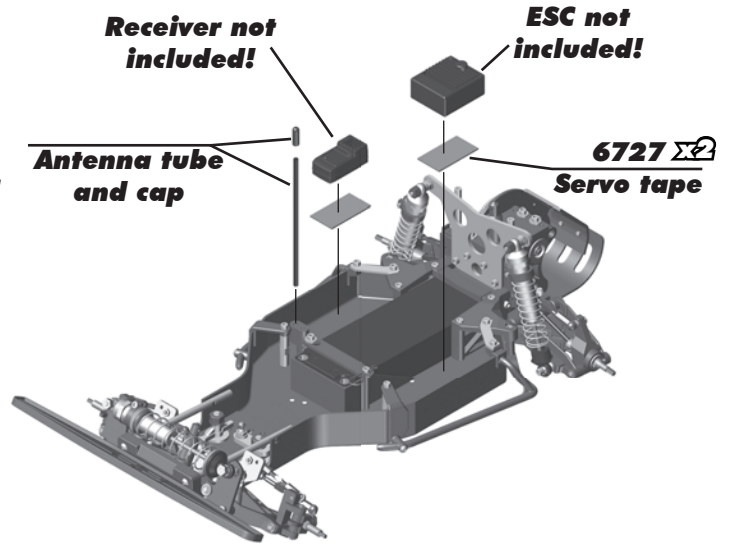
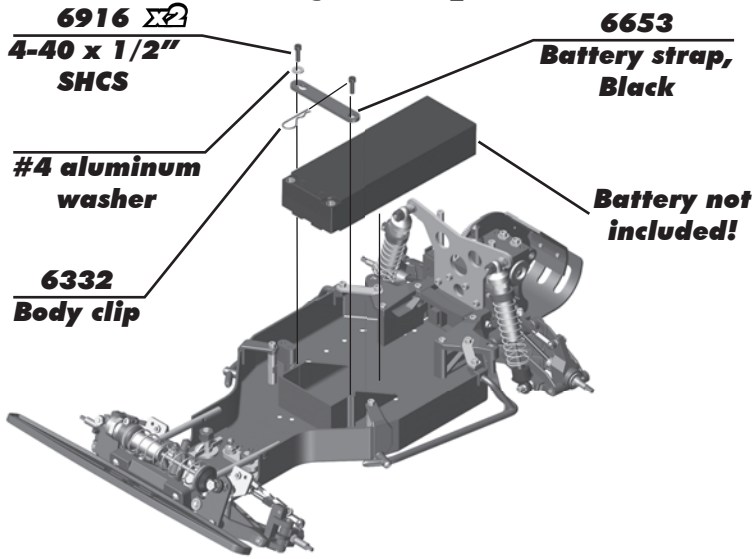

:: Steering Servo Build - Bag I/G - Step 1

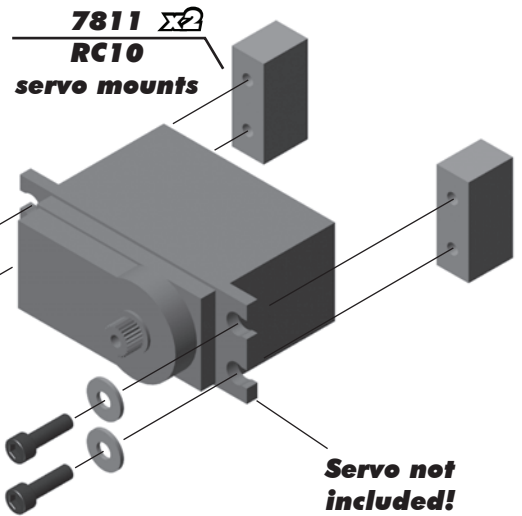
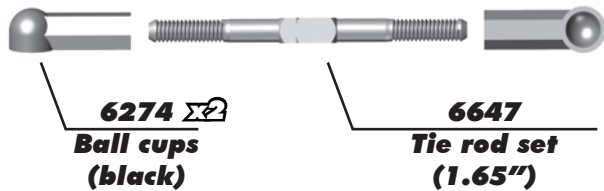

:: Steering Servo Build - Bag I - Step 2

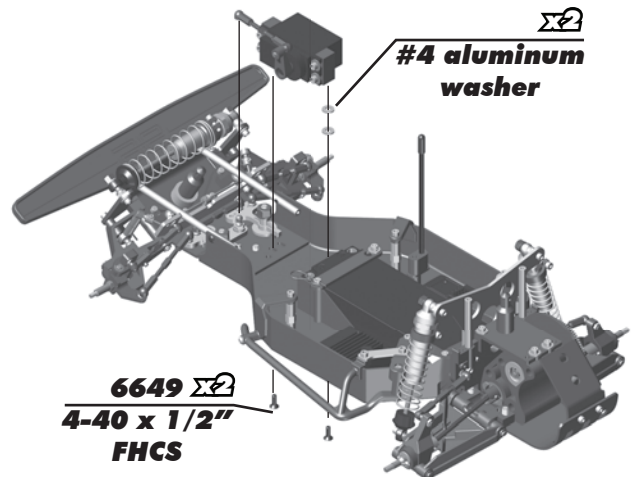
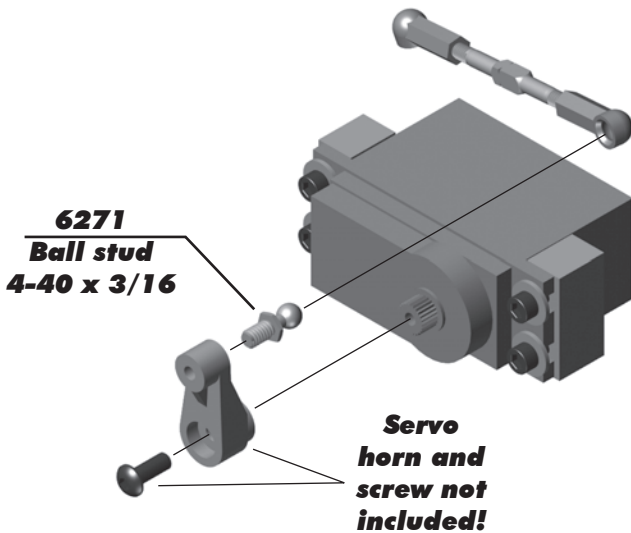

:: Wheels Tires, Body, and Accessories Build - Bag J - Step 1

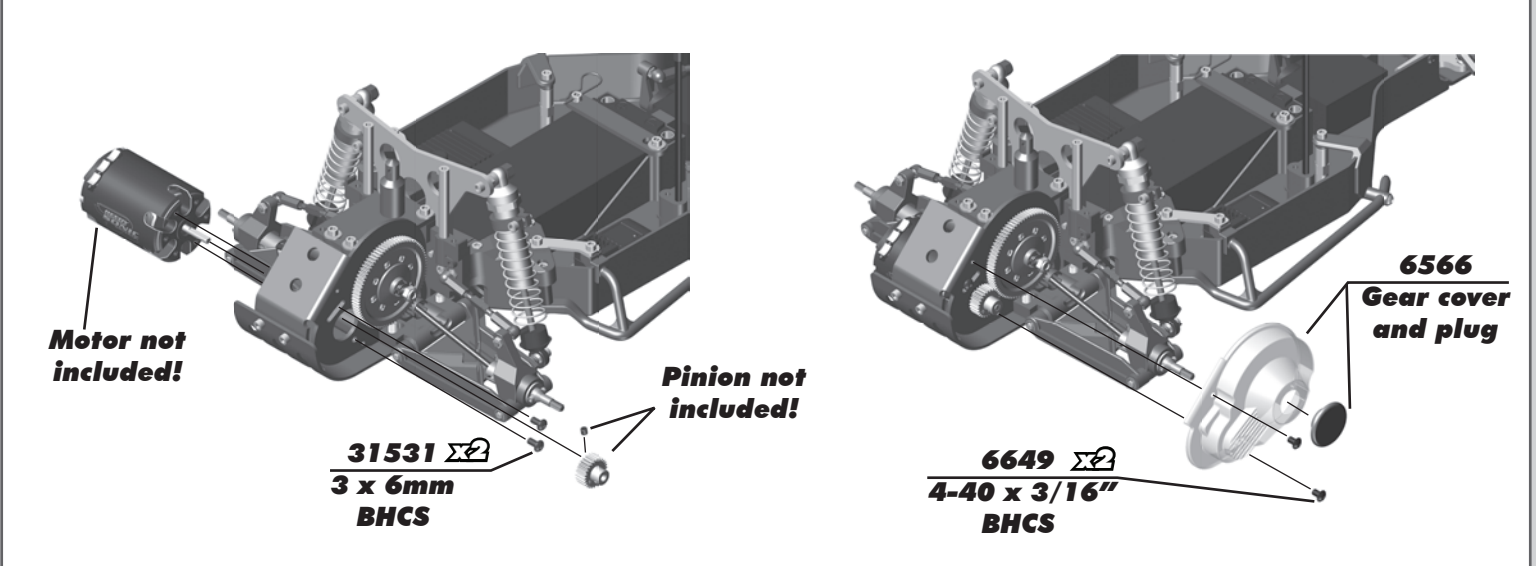

:: Wheels Tires, Body, and Accessories Build - Bag J - Step 2

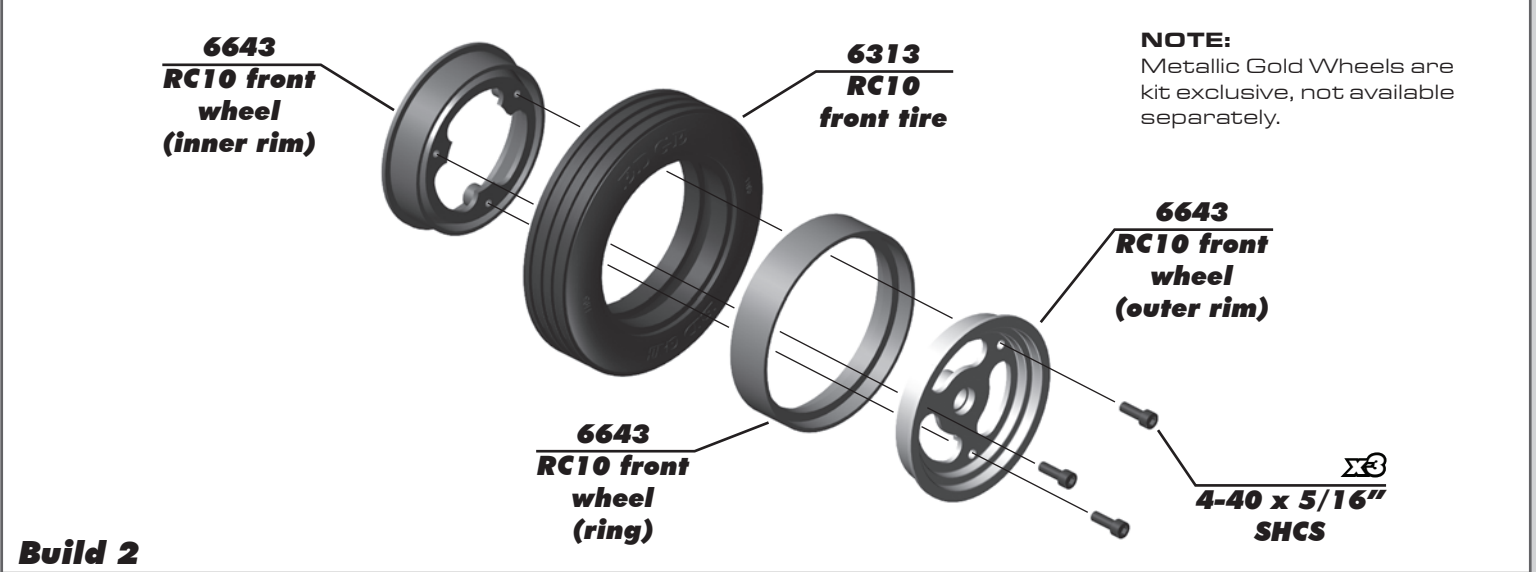

:: Wheels Tires, Body, and Accessories Build - Bag J - Step 3

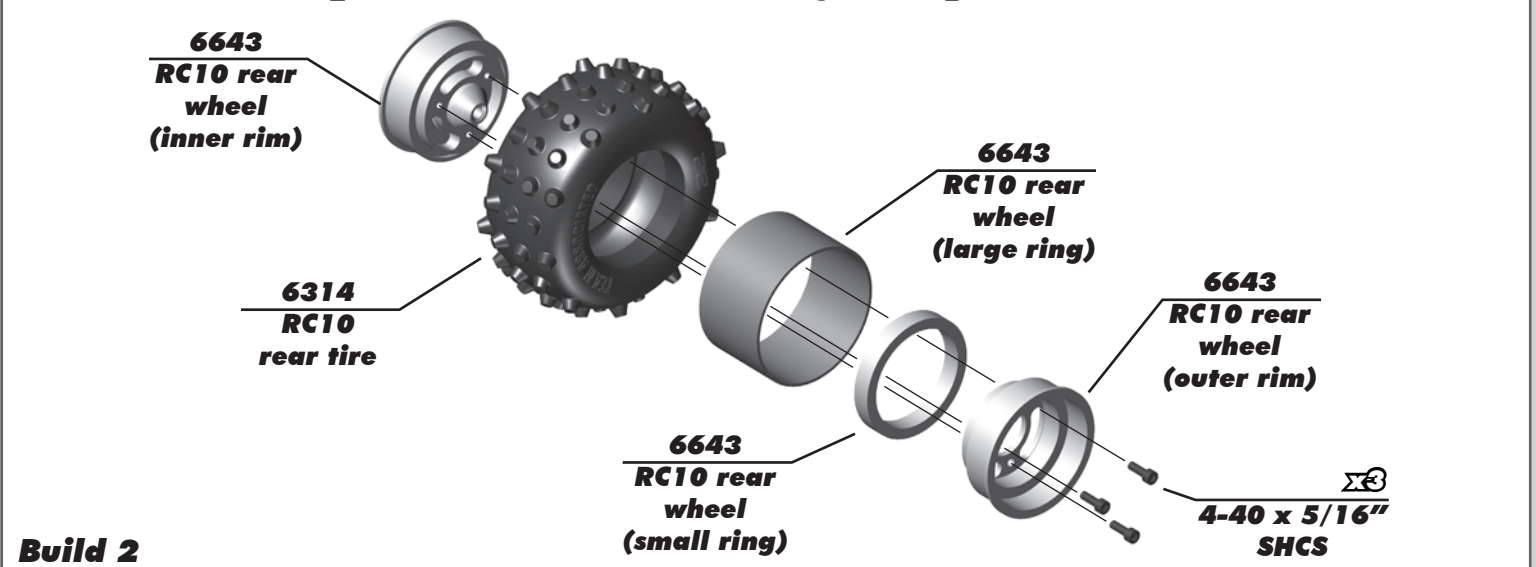

:: Wheels Tires, Body, and Accessories Build - Bag J - Step 4

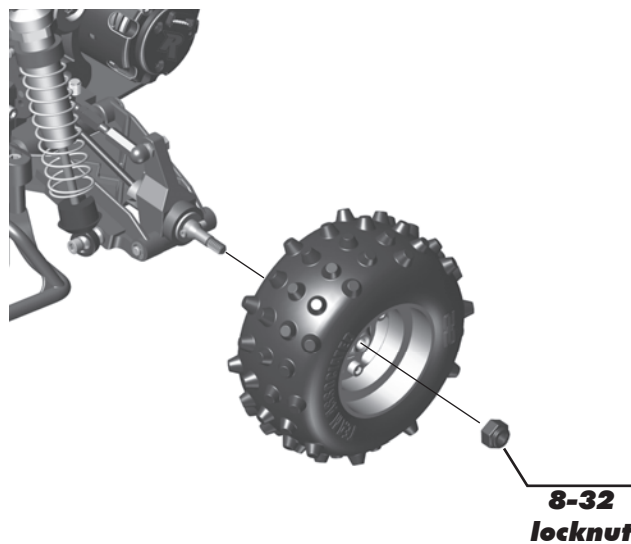
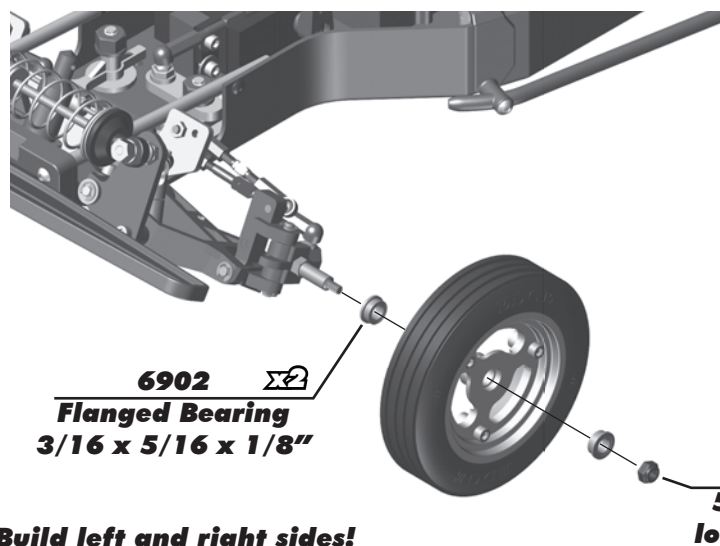

:: Wheels Tires, Body, and Accessories Build - Bag J - Step 5

Painting Tips:

Your RC 10 Kit comes with a clear polycarbonate body and wing. You will need to prep the body and wing before you can paint them. Wash the inside thoroughly with warm water and liquid detergent. Dry the body and wing using a clean, soft, lint-free cloth. Use high quality masking tape to make masks for the windows and install them on the inside of the body (RC cars get painted from the inside).

Using high quality masking tape, apply tape to the inside of the body to create a design. Spray (either rattle can or airbrush R/C specific paint) the paint to the inside of the body (preferably dark colors first, lighter colors last).

NOTE: use ONLY paint that is recommended for use with (polycarbonate) plastics. If you do not, you can destroy the plastic body and wing!!!!.

It is recommended to wear a mask while painting.

After the paint has dried, cut the body and wing along the trim lines. Make sure to drill or use a body reamer to make the holes for the body mounts, wing mounts, and antenna!

6121
RC10 Viper
Body, Clear

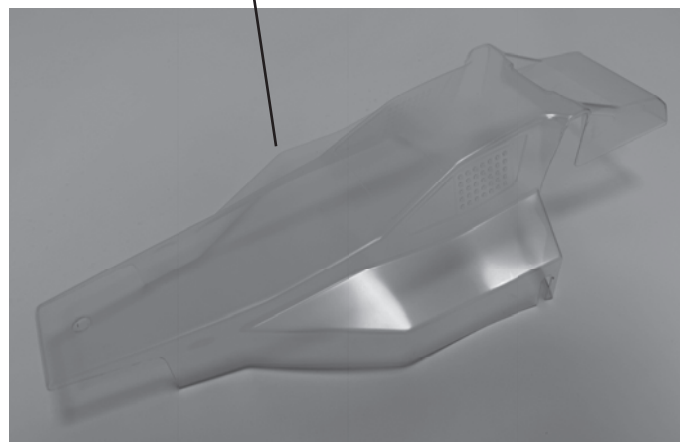

:: Wheels Tires, Body, and Accessories Build - Bag J - Step 6

Painting Tips:

Driver :

Your RC 10 Kit comes with a clear polycarbonate driver figure. You will need to prep the driver figure before you can paint it. Wash the inside and outside thoroughly with warm water and liquid detergent. Dry the driver figure using a clean, soft, lint-free cloth. The driver figure can be painted from the inside or the outside, depending on what type of finish you would like. If painted from the inside, the painted sections will appear glossy. If painted on the outside, the painted sections will appear flat or matte finished. Trim as shown and install inside the body using strapping tape. After painting, cut the body and wing along the trim lines.

NOTE: use ONLY paint that is recommended for use with (polycarbonate) plastics. If you don't, you can destroy the plastic body, driver figure, and wing!!!!.

RC10 driver
figure, clear



:: Wheels Tires, Body, and Accessories Build - Bag J - Step 7

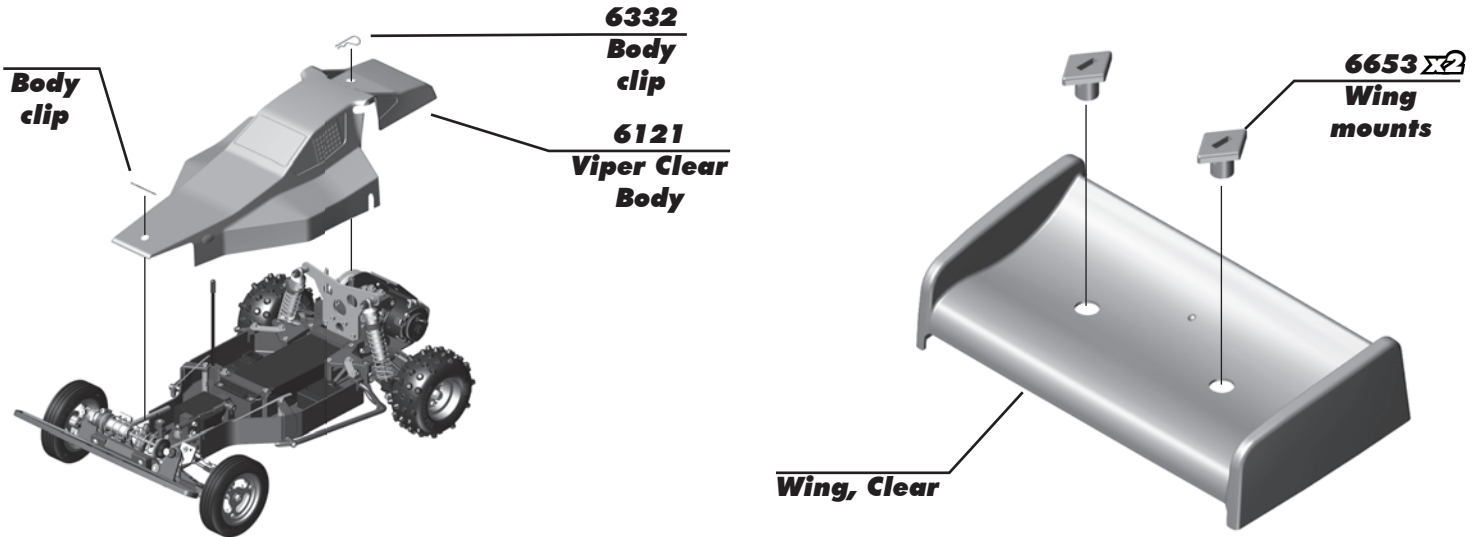

:: Wheels Tires, Body, and Accessories Build - Bag J - Step 8

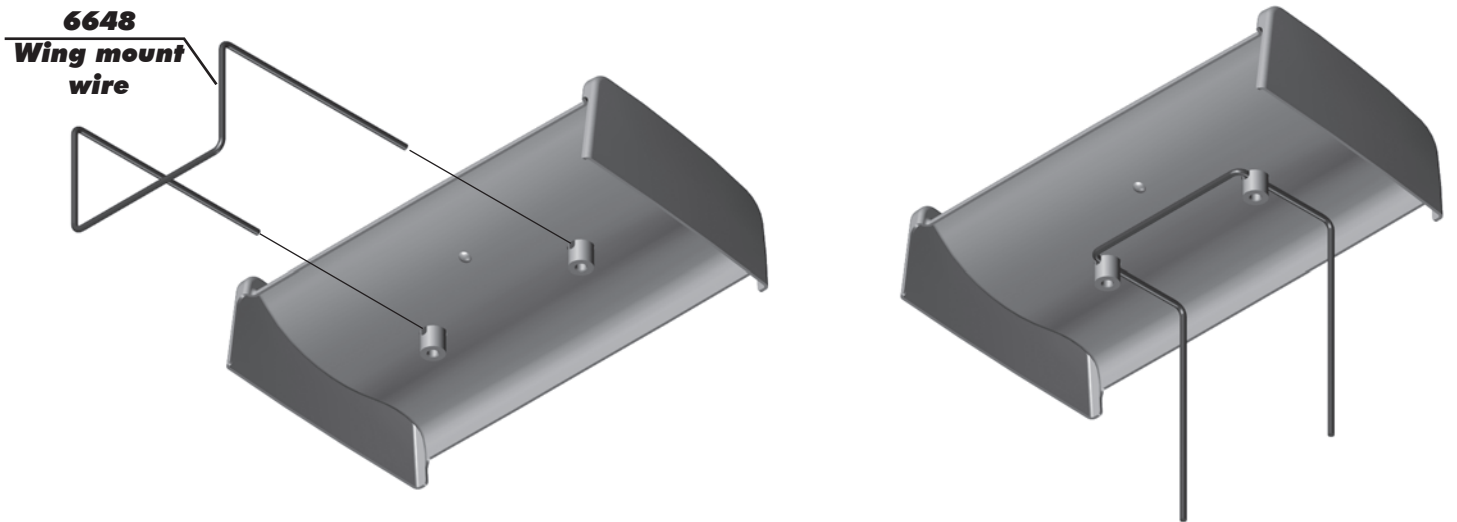

:: Wheels Tires, Body, and Accessories Build - Bag J - Step 9

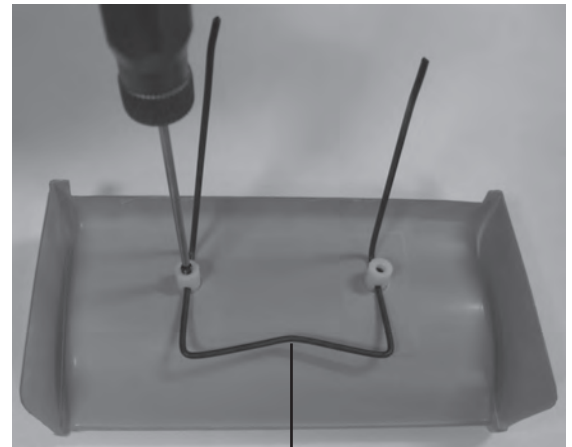
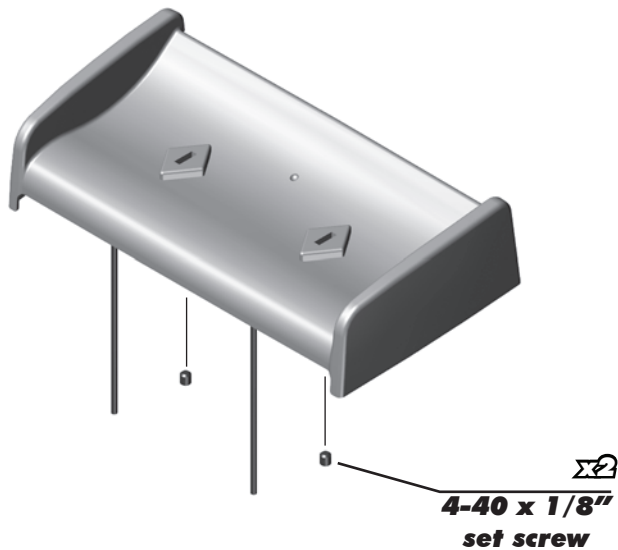

TIP: Bending the wire as shown can help ensure the wing buttons are parallel.

:: Wheels Tires, Body, and Accessories Build - Bag J - Step 10

TIP: Bend wire to create tight fit inside wing tubes.

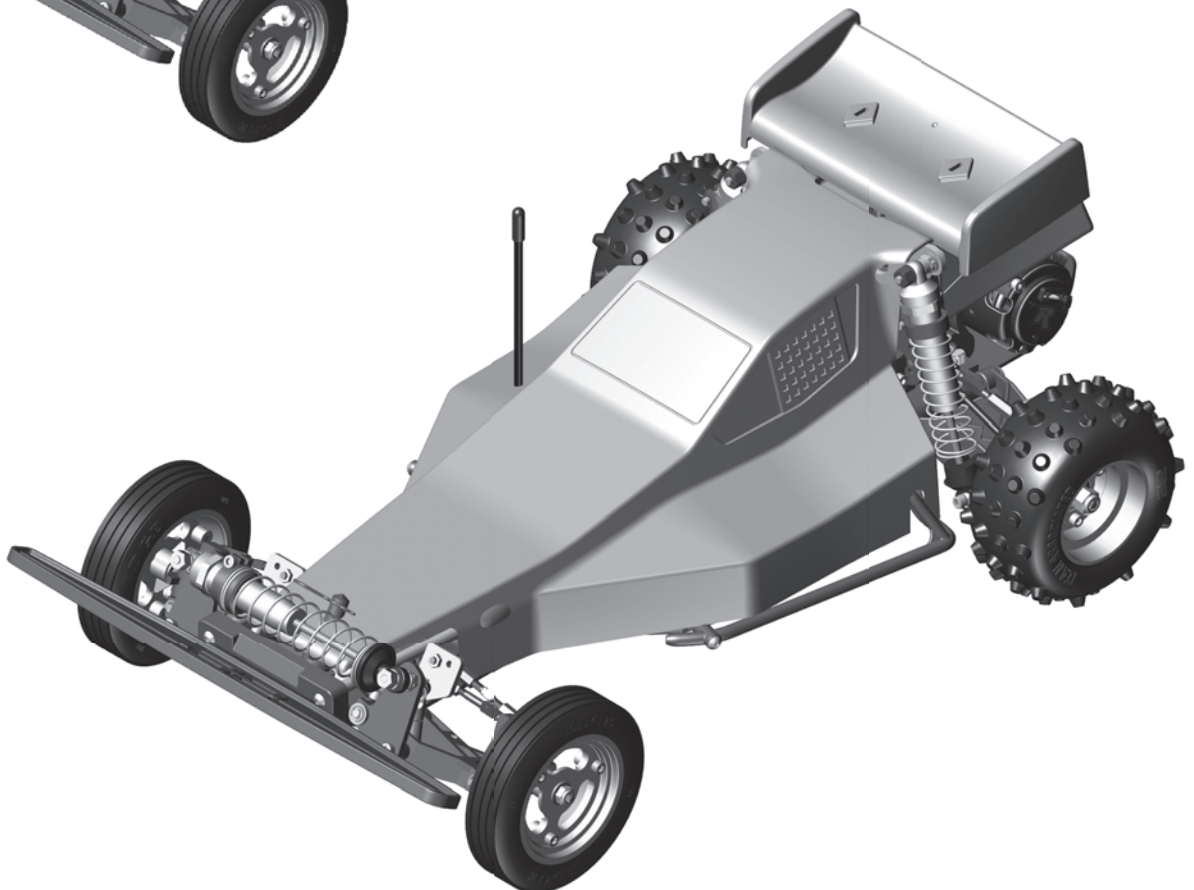
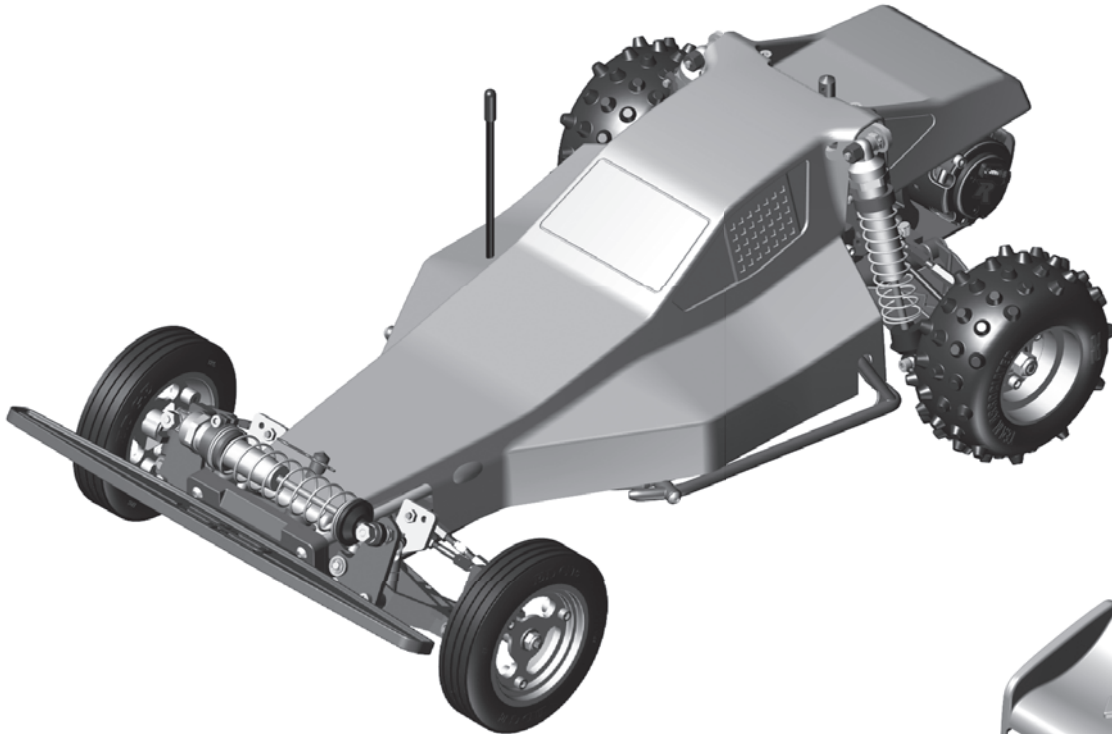



Associated Electrics, Inc.
21062 Bake Parkway Lake Forest, CA 92630 USA

call: (949) 544-7500 - fax: (949) 544-7501
Check out the following web sites for all of our kits, current products,
new releases, setup help, tips, and racing info!
www.AssociatedElectrics.com

FOLLOW US ON SOCIAL MEDIA



TeamAssociated
ReedyPower
ElementRC
FactoryTeam51



@TeamAssociatedRC
@ReedyPower
@Element_RC
@FactoryTeam_RC



@Team_Associated
@ReedyPower



@Associated_Electrics



TeamAssociatedRC
ElementRC



TeamAssociated
Reedy
Element-rc